



**BIAL**  
ALUMINIU SRL

**SIMTEX-OC**  
ISO 9001 REGISTERED 788.1.0

Fabrica: **POPESTI LEORDENI**, str. Lt. maj. av. Tănase Banciu nr. 2,

jud. ILFOV, Tel.: 021 361 59 52/53/54; Fax. 021 361 59 55

## Informatii generale

### *Stimați clienți,*

Societatea **BI-AL ALUMINIU** produce o gamă largă de profile extrudate la cald din aliaje de aluminiu, vopsite cu pulbere în câmp electrostatic, utilizate la tâmplărie metalică, confecții metalice, mobilier și în alte domenii.

Societatea noastră are o fabrică modernă în **POPESTI LEORDENI**.

Profilele sunt fabricate prin procedee tehnologice moderne: turnare continuă cu răcire zonală, extrudare la cald de precizie ridicată cu doua prese hidraulice automate comandate prin computer, tratament termic în cuptor cu ciclul complet automatizat, vopsire cu vopsea pulbere în câmp electrostatic pe doua linii automate dotate cu roboți, etc., care asigură stabilitatea procesului de producție și calitatea constantă. Sistemul de management al calității certificat conform SR EN ISO 9001:2001 și personalul de specialitate de înaltă calificare sunt garanția obținerii unor produse de foarte bună calitate.

Toate produsele noastre sunt fabricate din aliaje de înaltă puritate de tip **AlMgSi**, din mărcile **EN AW-6060(6063)**, conform **SR EN 573-3**, produse de **ALRO Slatina** pentru care se garantează compoziția chimică. După extrudare, profilele sunt tratate termic pentru uniformizarea, stabilizarea și mărirea caracteristicilor mecanice, precum și pentru eliminarea tensiunilor interne. Caracteristicile mecanice minime obținute corespund stării de livrare **T6** conform **SR EN 515** și sunt, conform **SR EN 755-2**, următoarele:

- Rezistența la rupere  $R_m$  190...215 MPa
- Limita de curgere  $R_{p0.2}$  150...170 MPa
- Alungirea la rupere  $A_{50}$  min 6%
- Duritatea Brinell 65...75 HBR

Condițiile tehnice de inspecție și de livrare sunt conforme cu **SF 1**, **SR EN 755-1** și **SR EN 12020-1:2001**. Profilele sunt vopsite, după o pregătire chimică corespunzătoare a suprafețelor, cu vopsea pulbere în câmp electrostatic, în culorile comandate de client, dar se pot livra și profile natur.

Profilele fabricate de noi au toate caracteristicile tehnice, conform standardelor internaționale pentru acest tip de produse, astfel:

- Utilizarea aliajelor de calitate și a tratamentelor termice corecte asigură caracteristicile mecanice garantate;
- Grosimea minimă a peretelui de **1,2 mm** asigură rezistența și rigiditatea necesară, precum și posibilitatea asamblărilor cu șuruburi autofiletante;
- Extrudarea de precizie ridicată asigură toleranțe foarte mici pentru dimensiunile secțiunii transversale, la linearitate și planeitate, asigurând montajul corect și îmbinarea perfectă;
- Tratamentul chimic al suprafețelor printr-o tehnologie modernă și ecologică de conversie chimică, aplicarea unei vopsiri de calitate superioară cu pulbere poliesterică în câmp electrostatic și grosimea stratului de vopsea de minim **60...80 μm** asigură aderența și rezistența peliculei pe o durată de minim 10 ani, fără apariția decolorării sau exfolierii peliculei;
- Fabricarea îngrijită, controlul de calitate sever și un ambalaj corespunzător care protejează produsele pe timpul transportului și depozitării elimină posibilitatea deformării sau zgârierii lor.

Desfacerea produselor noastre se face din depozitul fabricii, printr-o rețea de distribuitori independenți, care pun la dispoziția Dvs. atât seriile de profile produse de **BI-AL**, conform catalogului, cât și întreaga gamă de accesorii necesare de la producători specializați: feronerie, garnituri, elemente de asamblare, chituri și masticuri de etanșare, etc.

Deasemenea distribuitorii pun la dispoziția constructorilor gama completă de mașini, scule și dispozitive pentru executarea corectă, rapidă și de calitate a confecțiilor metalice din profile de aluminiu.

Magazine de prezentare și desfacere ale distribuitorilor sunt în orașele: **București, Pitești, Slatina, Craiova, Târgu Jiu, Râmnicu Vâlcea, Drobeta Turnu Severin, Deva, Alba Iulia, Târgu Mureș, Ploiești, Târgoviște, Tecuci, Bacău, Râmnicu Sărat, Vaslui, Iași, Galați, Brăila, Constanța.**

În afară de profilele cuprinse în catalog fabricăm la comandă orice profil din aluminiu cu secțiunea maximă înscrisă într-un cerc cu diametrul de 160 mm.

Specialiștii noștri sunt permanent la dispoziția Dvs. pentru consultanță și informații în orice problemă legată de domeniul nostru de activitate și de necesitățile Dvs. Vă invităm să ne contactați la sediul societății sau prin **www.bial.ro** sau **bial@bial.ro**.



### *Dear customers,*

**BI-AL ALUMINIU** Company produces a variety of aluminum alloy extruded profiles, painted with powder in electrostatic field, trade designation, used in metallic work, metal joinery for architectural applications and other domains.

Our company has a modern factory in **POPESTI LEORDENI (near BUCHAREST)**.

These profiles are manufactured with an up-to-date process (continuously casting with zonal cooling, high precision hot extruding with two automatic hydraulic press computer controlled, ageing treatment in full automation furnace, painting with powder paint in electrostatic field on two automatic line with robots, etc.) which assure the production process stability and the constancy quality.

All our products are made from high pure alloys **AlMgSi** type, **EN AW-6060 (6063)**, according to **SR EN 573-3**, chemical composition guaranteed. After extruder, our profiles are age hardened at 195 °C for homogenization, stabilization and increasing of mechanical characteristics, same as for elimination of internal tensions. The minimal mechanical characteristics obtained answer to delivery status **T6 (SR EN 515)** and are, according to **SR EN 755-2**, as the following:

□ Tensile strength	Rm	195...215 MPa
□ Yield strength	Rp0.2	150...170 MPa
□ Elongation	A5o	min 6%
□ Brinell hardness	HBR	65...75

Inspection and delivery technical conditions are according to **SF 1-2001**, **SR EN 755-1:2001** and **SR EN 12020-1:2001**. The profiles are painted, after a suitable chemical preparation of the surfaces, with powder paint in electrostatic field, with the color ordered by the client, but the profiles can be delivered both anodized and in natural color.

The profiles manufactured by our company have all the technical characteristics, according to the international standards for this type of products, as:

- The quality of the alloys used and the appropriate thermal treatments assure the certified mechanical characteristics;
- The **1,2 mm** minimal wall thickness assure the needed endurance and stiffness, same as the possibility of assembling using self thread screws;
- The high precision extrusion assure very small tolerance for the sectional dimensions, linearity, convexity-concavity, assuring the right joint and fitting;
- The chemical treatment of the surfaces, using an up-to-date & ecological chemical translation technology, the high quality painting with polyester powder in electrostatic field and the **60...80 µm** minimal painting thickness assure the adhesiveness and the endurance of the coating for at least 10 years, without discoloration or exfoliation;
- Carefully manufactured, sever quality control and a proper packing, that protects the products during the transportation and storage, eliminate the possibility of distortion or scratching.

Show & selling-out shops are located in **Bucureşti, Piteşti, Slatina, Craiova, Târgu Jiu, Râmnicu Vâlcea, Drobeta Turnu Severin, Deva, Alba Iulia, Târgu Mureş, Ploieşti, Târgovişte, Tecuci, Bacău, Râmnicu Sărat, Vaslui, Iaşi, Galaţi, Brăila, Constanţa**.

We offer you any profiles system, as in the catalog, but also all the accessories: copper fittings, fixings, assembling elements, lutes, mastic seal etc. Also, we offer for the constructors all the machines, tools and dispositions for the right, quickly and the quality execution of the metal joinery from aluminum profiles. We also can offer you, on demand, any aluminum profile with a maximum section by 160 mm diameter.

Our specialists are all the time at your service for consultation and information in any problem by our activity domain and your needs. You have all our attention and support in order to get a efficacious collaboration. Don't hesitate to visit us on our show & selling-out shops, or our factory, or to **www.bial.ro** and **bial@bial.ro**



## P01 - seria de profile IZOTERM

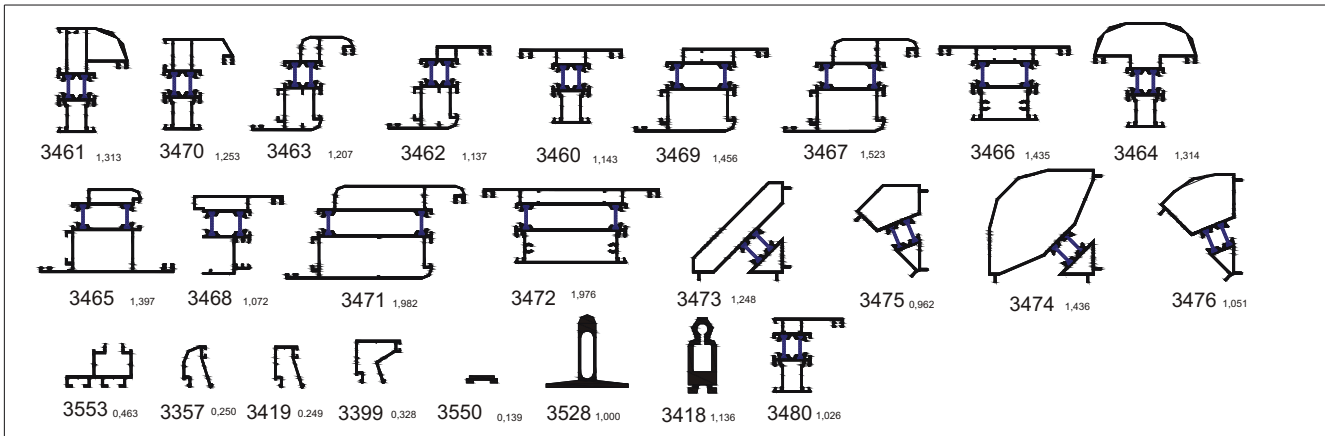

## P02 - seria de profile NORMAL

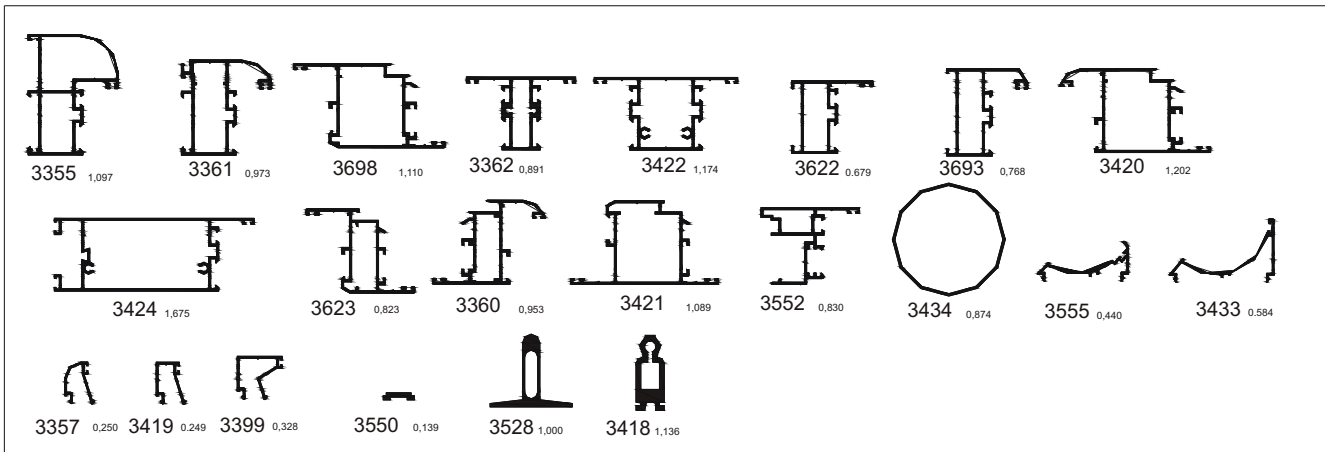

## P03 - seria de profile ECONOMIC

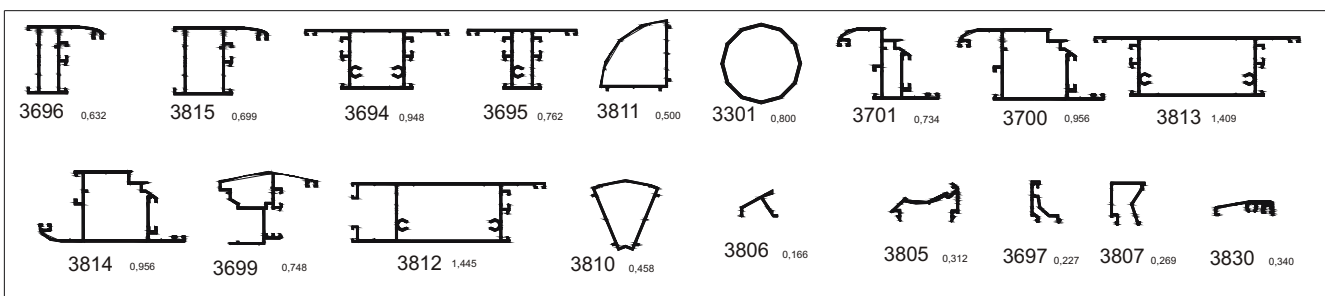

## P04 - seria de profile ALDOX

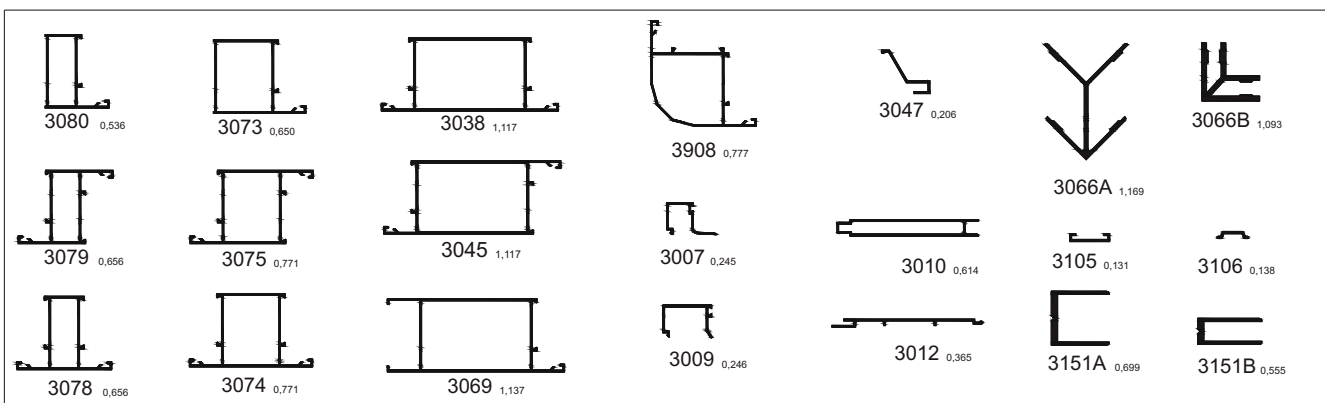

## P05 - seria de profile GLISANT

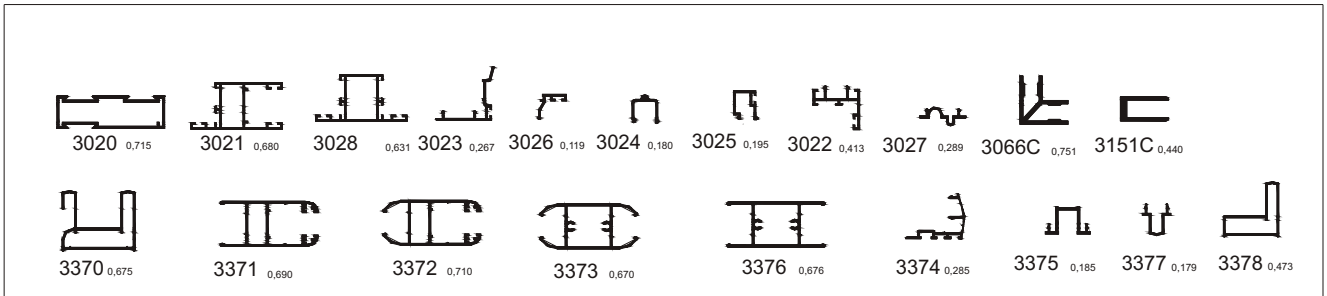

## P06 - seria de profile PERETI CORTINA

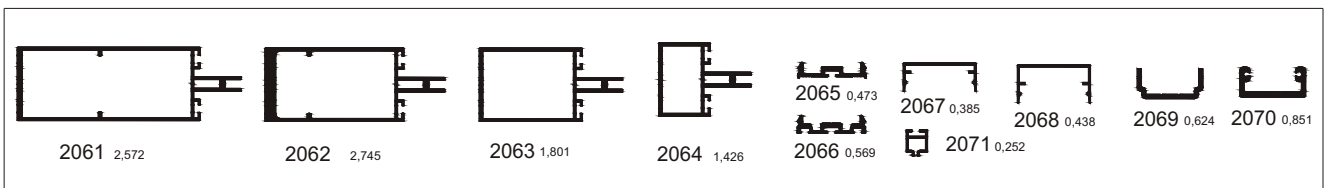

## P07 - seria de profile C-60

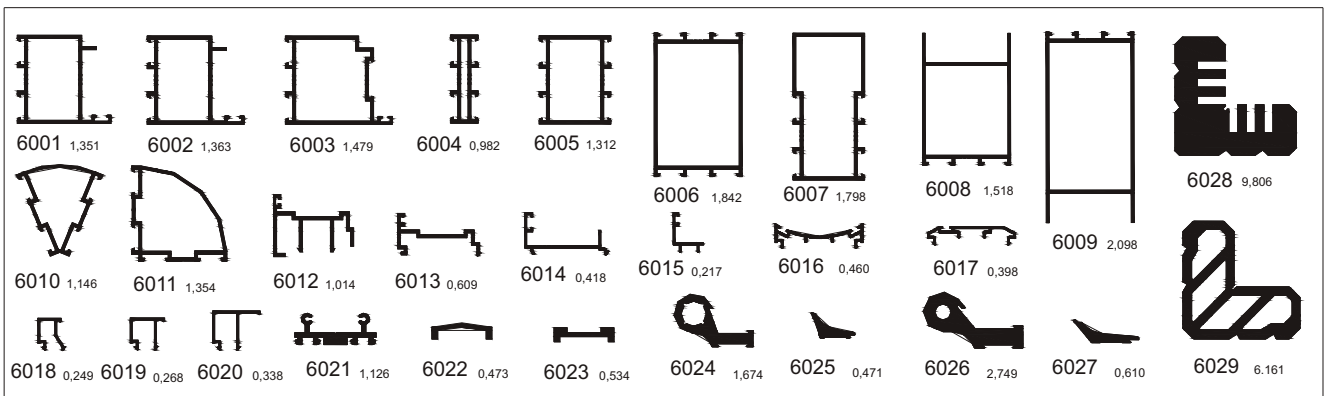

## P08 - seria de profile RAFTURI

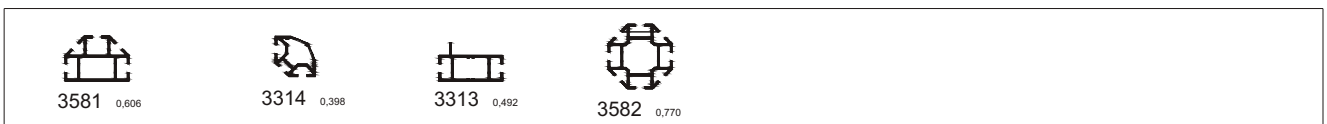

## P09 - profile DIVERSE

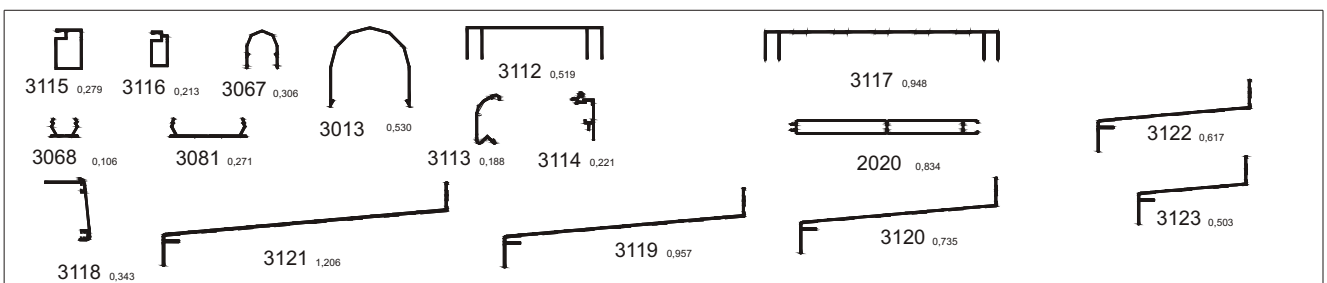

## P10 - profile STANDARD

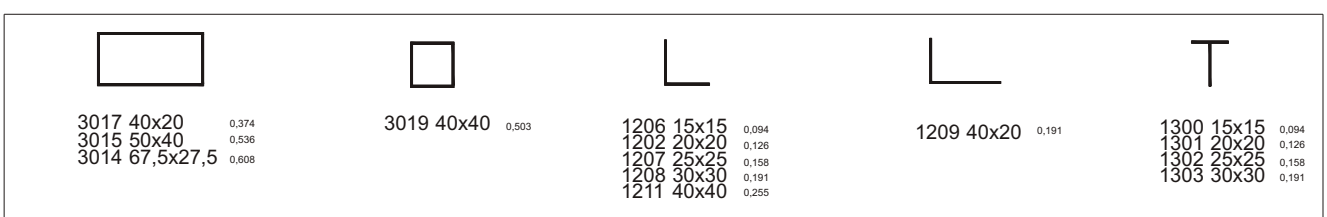



***P01 – SERIA DE PROFILE IZOTERM***

***P02 - SERIA DE PROFILE NORMAL***

***P03 - SERIA DE PROFILE ECONOMIC***

***P04 – SERIA DE PROFILE ALDOX***

***P05 - SERIA DE PROFILE GLISANT***

***P06 - SERIA DE PROFILE PERETI CORTINA***

***P07 – SERIA DE PROFILE C-60***

***P08 – SERIA DE PROFILE PENTRU RAFTURI***

***P09 – PROFILE DIVERSE***

***P10 – PROFILE STANDARD***

**NOTĂ:**

1. Masa profilelor din catalog este teoretică și se referă la profile natur.
2. Pentru profile vopsite se adaugă în plus 4...5%.
3. Datorită toleranțelor la grosimea profilelor admise de standard SR EN 12020:2001, masa profilelor poate fi diferită cu până la  $\pm 20\%$ , funcție de mărimea și configurația profilelor.
4. Pentru a fi siguri că o cantitate de profile este suficientă pentru o anumită construcție, toate calculele și comenzile se vor face în metri liniari sau număr de bare.

Cod	Denumire profil	kg / m
3461	Toc rotund	1,363
3470	Toc drept	1,204
3463	Cercevea rotund	1,288
3462	Cercevea drept	1,209
3467	Cercevea rotund mare	1,524
3469	Cercevea drept mare	1,482
3471	Cercevea rotund greu	1,981
3460	Teu drept mic	1,168
3466	Teu mare	1,506
3464	Teu rotund	1,411
3468	Adaptor	1,098
3465	Teu usa exterioara	1,465
3472	Plinta usa	2,063
3553	Portperie	0,463
3357	Bagheta	0,250
3419	Bagheta	0,249
3399	Bagheta	0,328
3550	Sina	0,139
3528	Piesa imbinare	1,000
3418	Piesa imbinare	1,136
3473	Colt 90° drept	1,284
3474	Colt 90° rotund	1,446
3475	Colt 45° drept	0,962
3476	Colt 45° rotund	1,062
3480	Toc economic	1,026

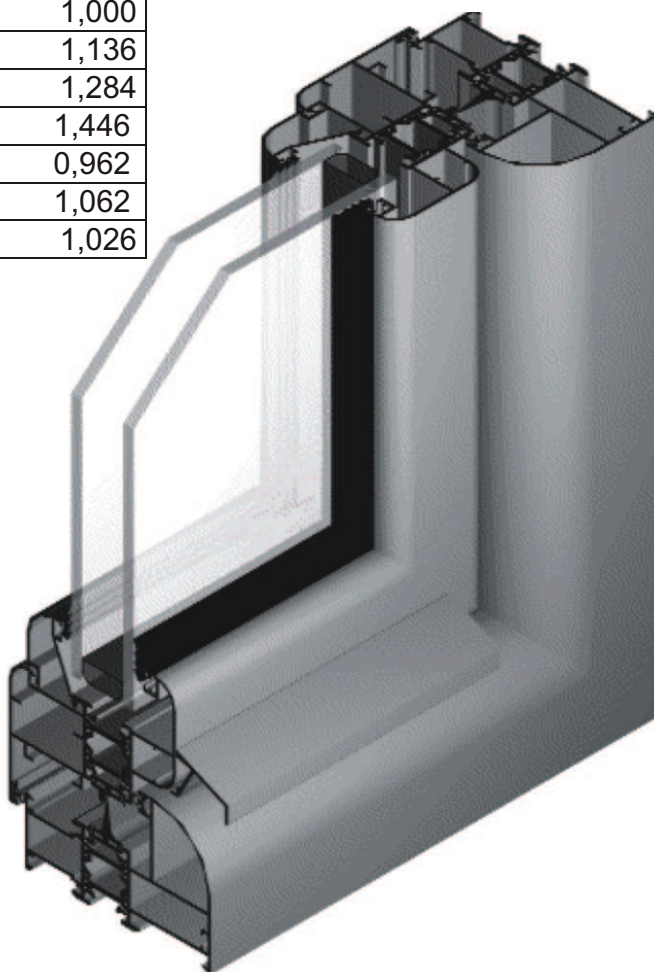



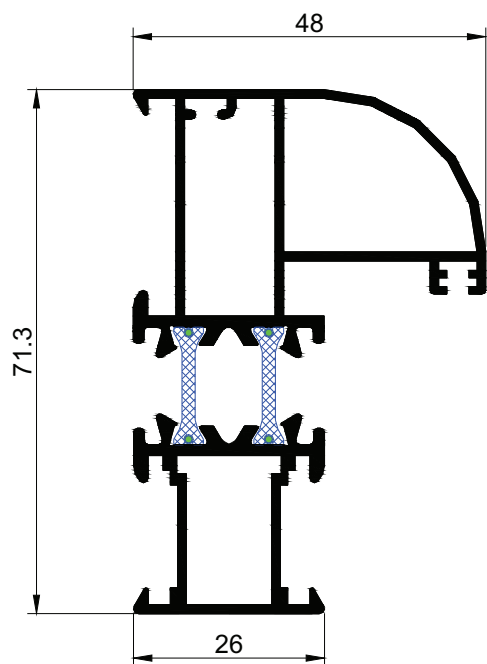

**3461**  $m = 1,313 \text{ kg/m}$

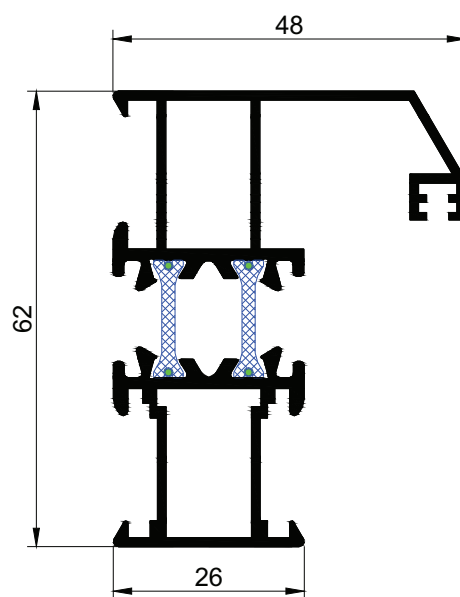

**3470**  $m = 1,253 \text{ kg/m}$

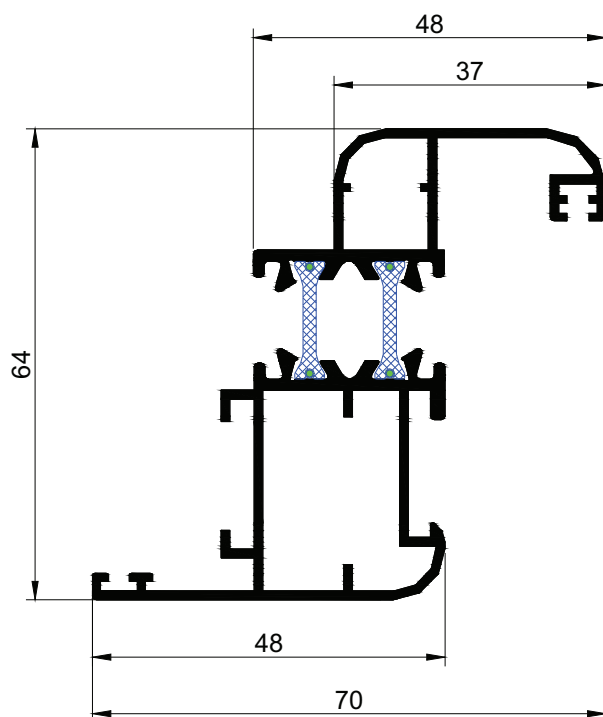

**3463**  $m = 1,207 \text{ kg/m}$

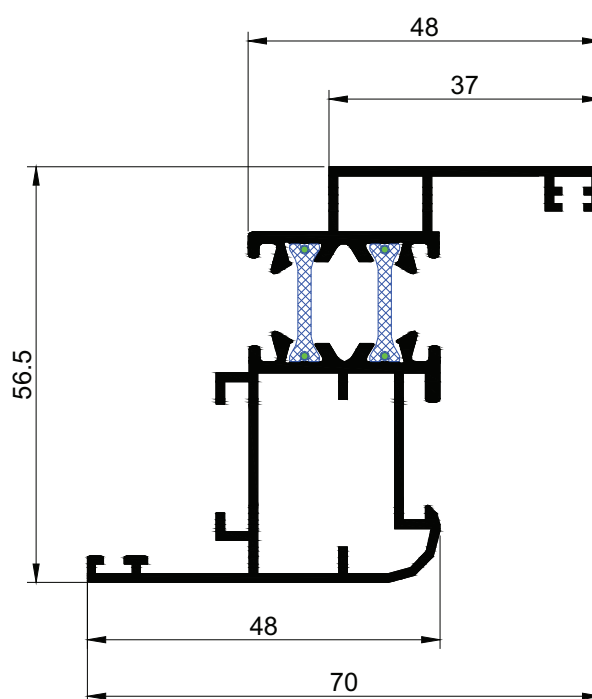

**3462**  $m = 1,137 \text{ kg/m}$

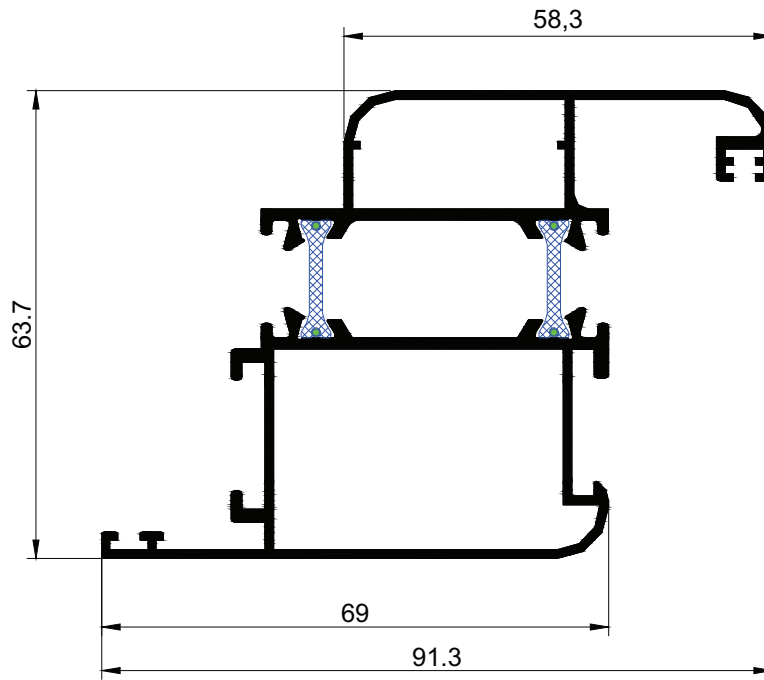

**3467** m = 1,523 kg/m

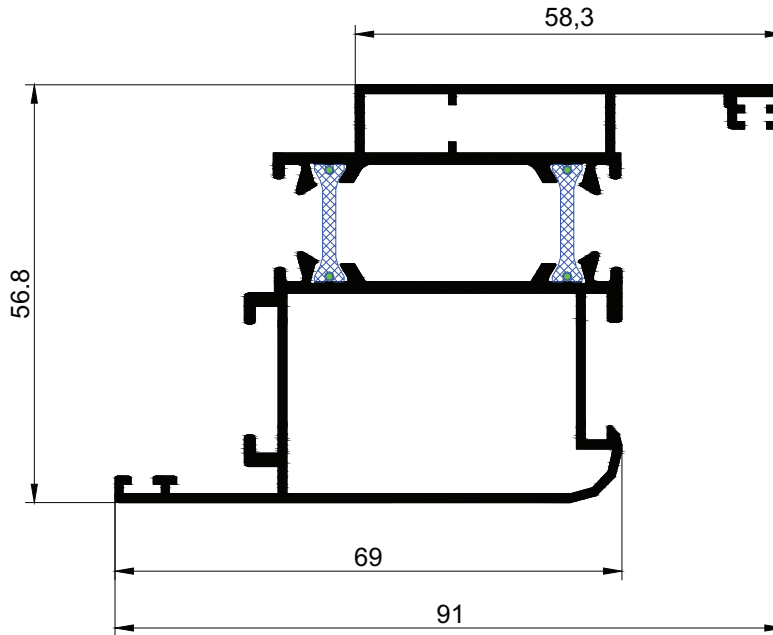

**3469** m = 1,456 kg/m

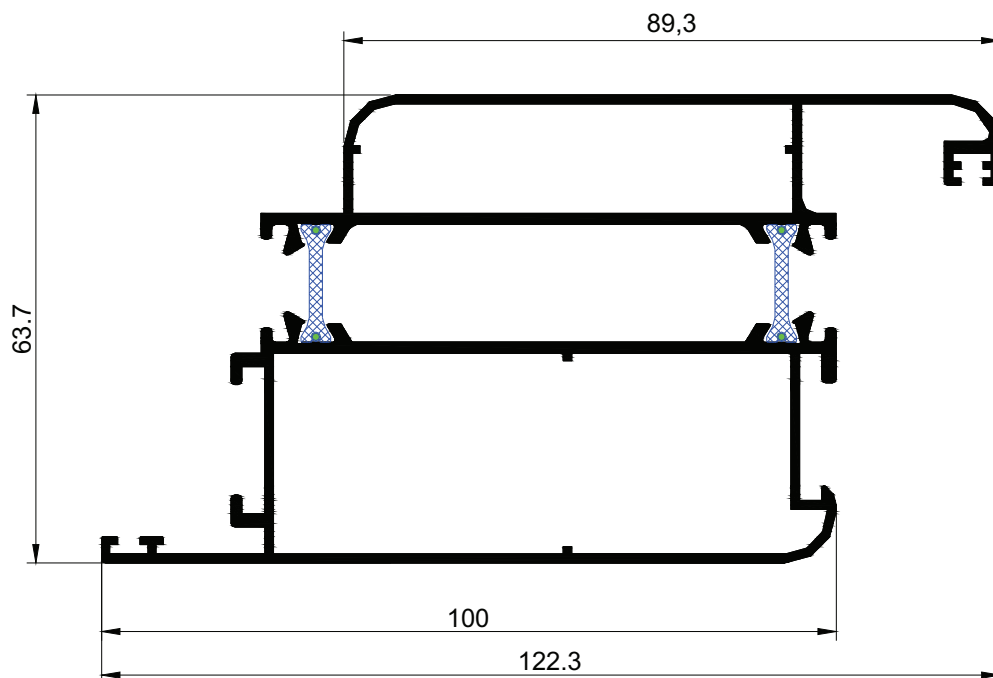

**3471**  $m = 1,982 \text{ kg/m}$

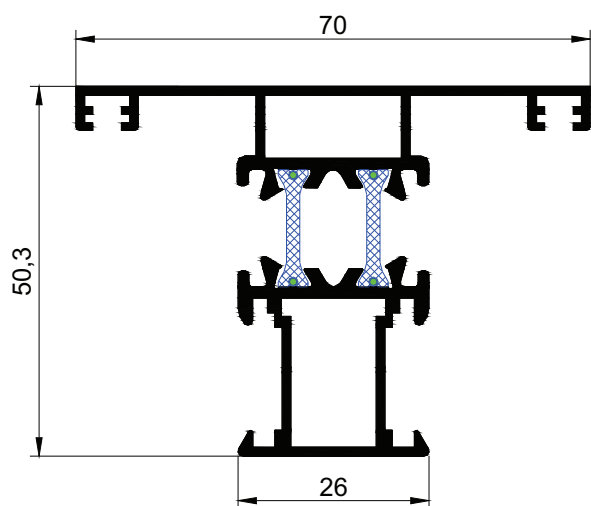

**3460**  $m = 1,143 \text{ kg/m}$

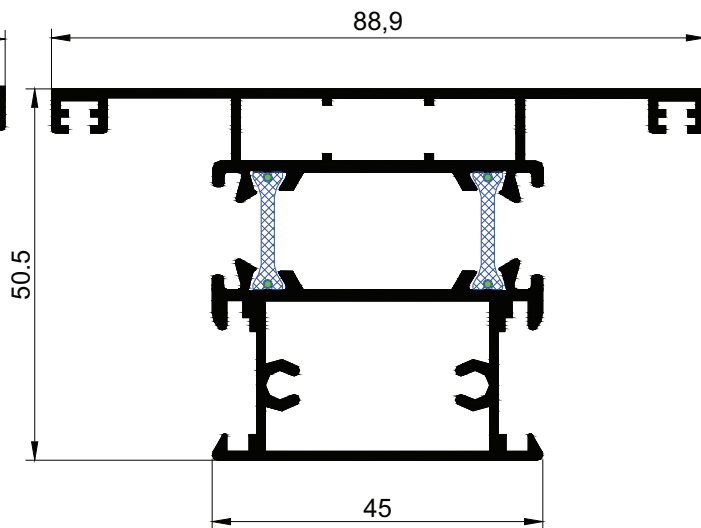

**3466**  $m = 1,435 \text{ kg/m}$

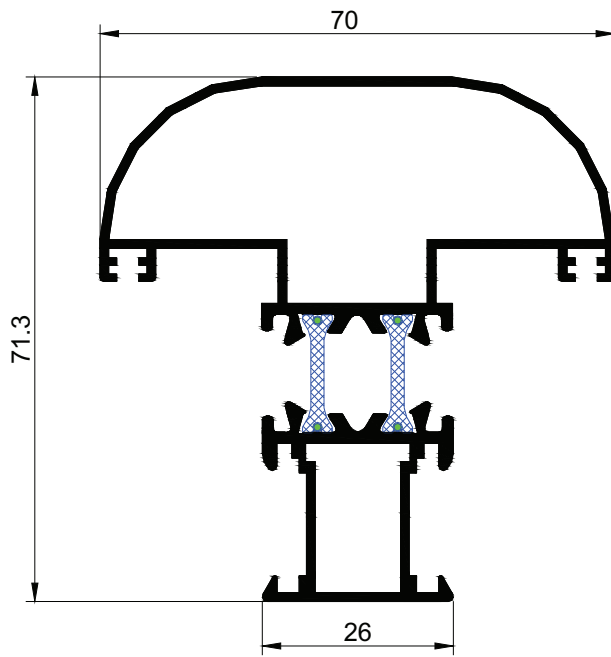

**3464**  $m = 1,314 \text{ kg/m}$

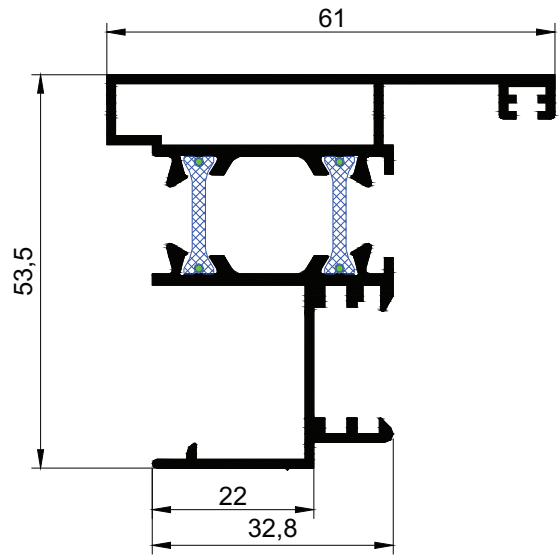

**3468**  $m = 1,072 \text{ kg/m}$

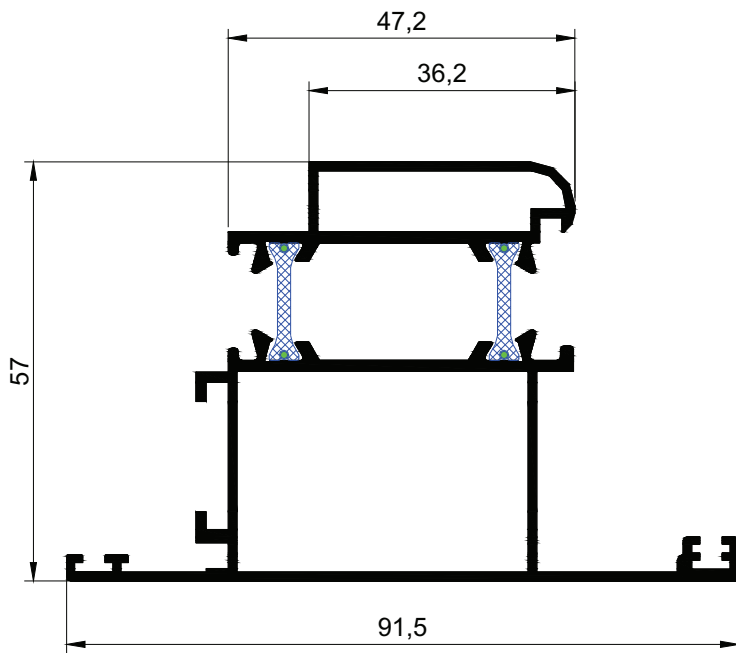

**3465**  $m = 1,397 \text{ kg/m}$

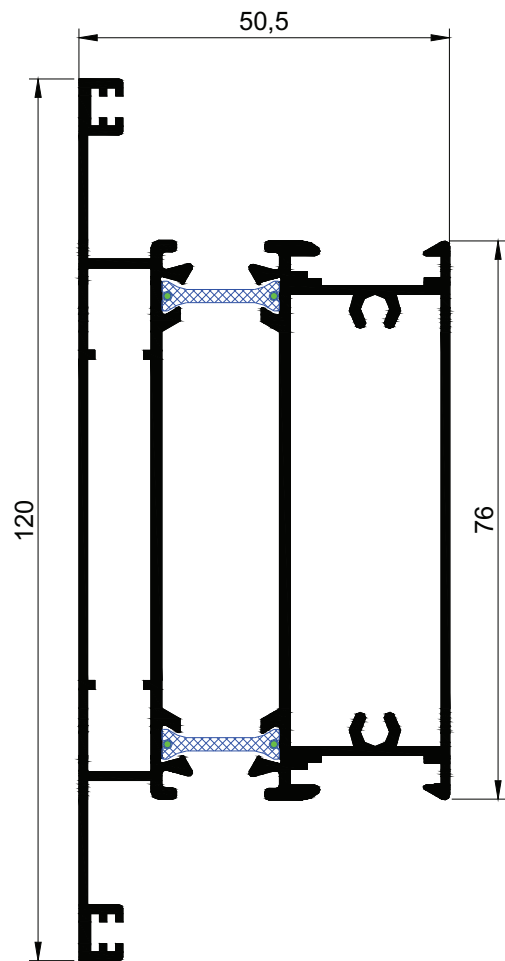

**3472**  $m = 1,976 \text{ kg/m}$

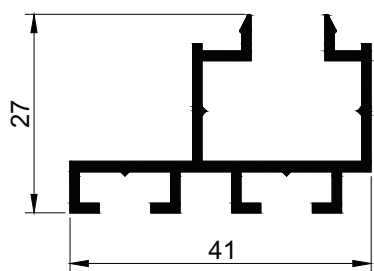
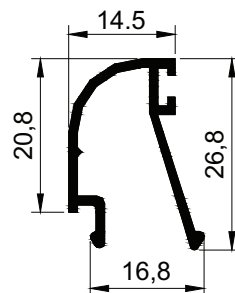
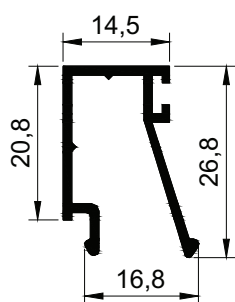
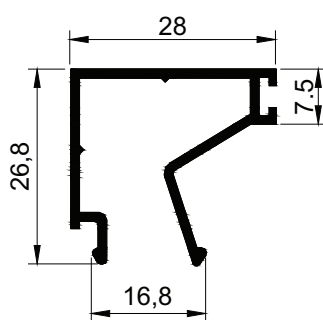
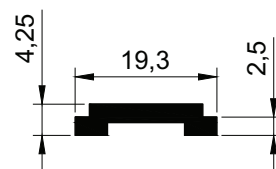
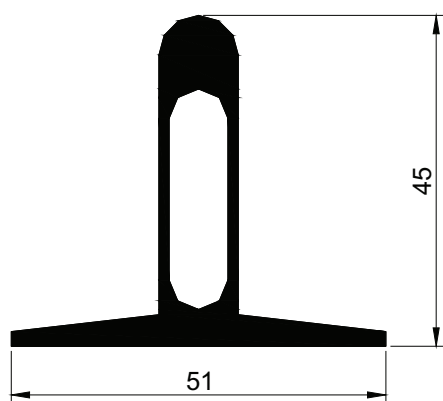
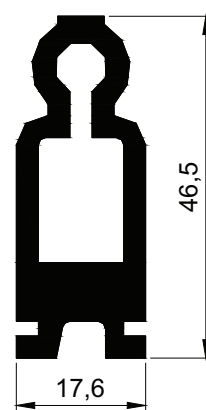

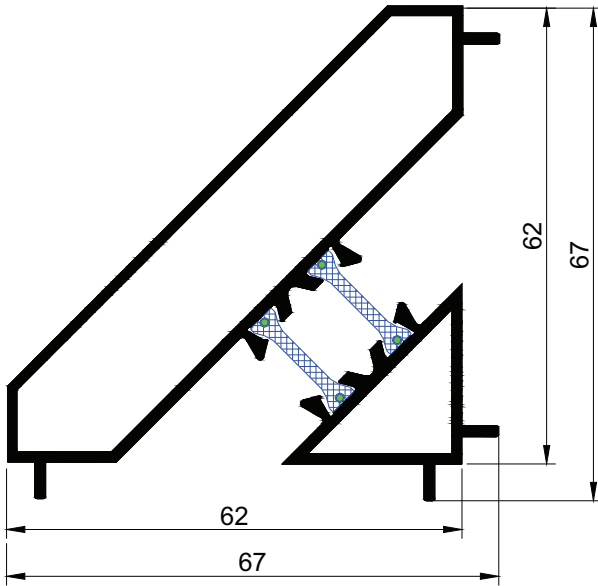
**3553**  $m = 0,463 \text{ kg/m}$ 

**3357**  $m = 0,250 \text{ kg/m}$ 

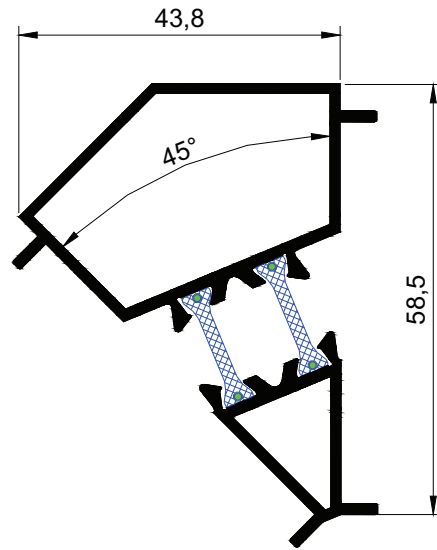
**3419**  $m = 0,249 \text{ kg/m}$ 

**3399**  $m = 0,328 \text{ kg/m}$ 

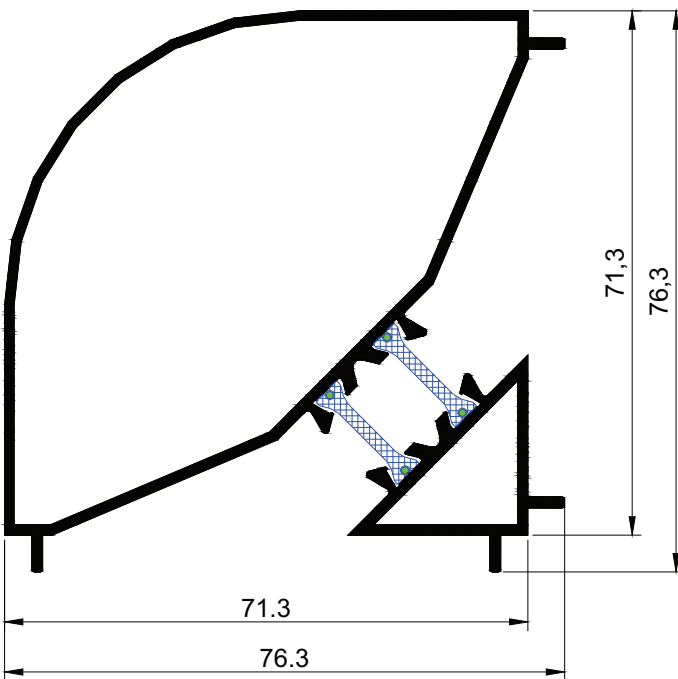
**3550**  $m = 0,139 \text{ kg/m}$ 

**3528**  $m = 1,000 \text{ kg/m}$ 

**3418**  $m = 1,136 \text{ kg/m}$



**3473**  $m=1,284$  kg/m



**3475**  $m=0,962$  kg/m



**3474**  $m=1,436$  kg/m

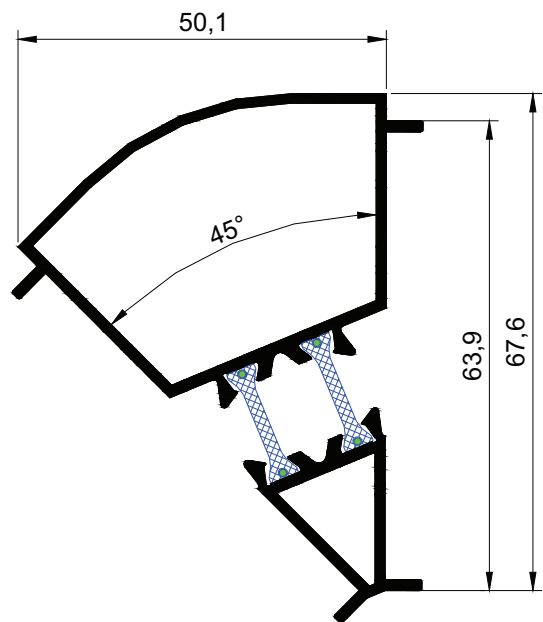

**3476**  $m=1,051$  kg/m

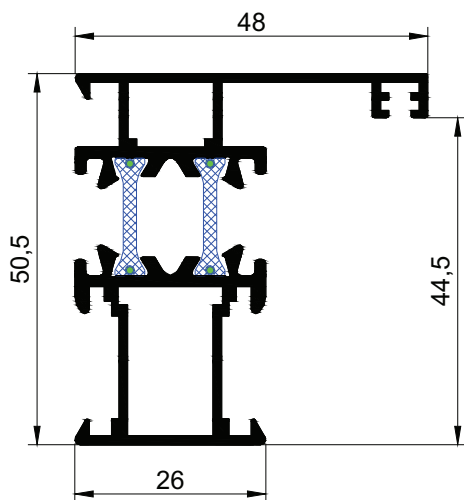

**3480**  $m = 1.026 \text{ kg/m}$





Cod	Denumire profil	kg / m
3355	Toc rotund mare	1,097
3361	Toc rotund	0,973
3622	Toc drept mic	0,679
3693	Toc drept	0,768
3623	Cercevea drept	0,823
3360	Cercevea rotund	0,953
3698	Cercevea drept mare	1,110
3420	Cercevea rotund mare	1,202
3421	Teu usa exterioara	1,089
3362	Teu	0,891
3422	Teu mare	1,174
3424	Plinta usa	1,675
3552	Adaptor	0,830
3434	Teava Ø70x1,5	0,874
3433	Profil colt	0,584
3555	Profil colt	0,440
3357	Bagheta	0,250
3419	Bagheta	0,249
3399	Bagheta	0,328
3550	Sina	0,139
3528	Piesa imbinare	1,000
3418	Piesa imbinare	1,136

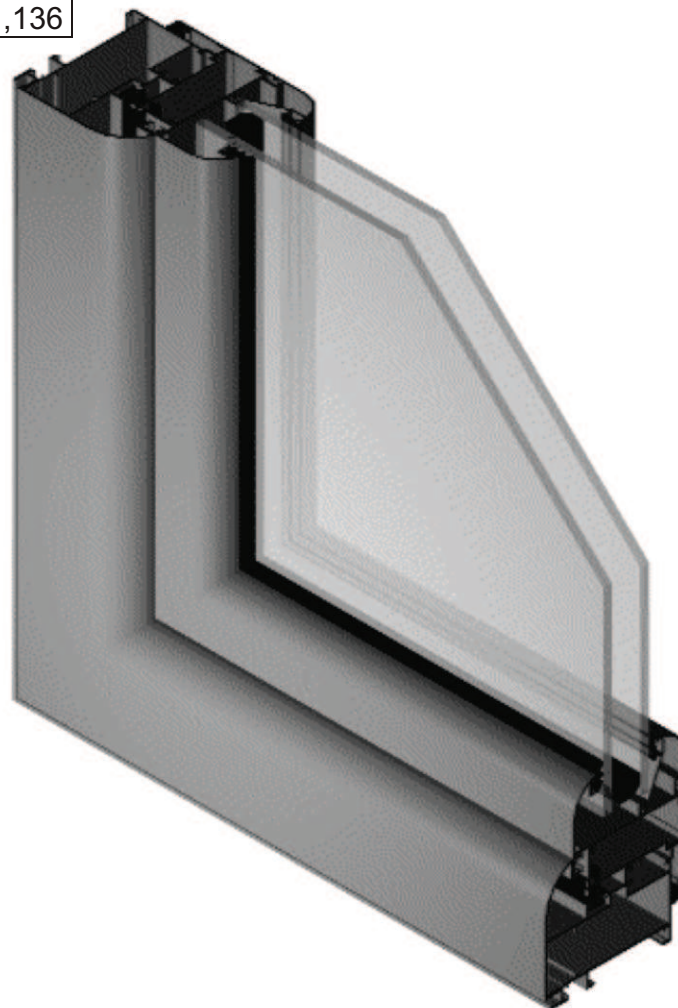

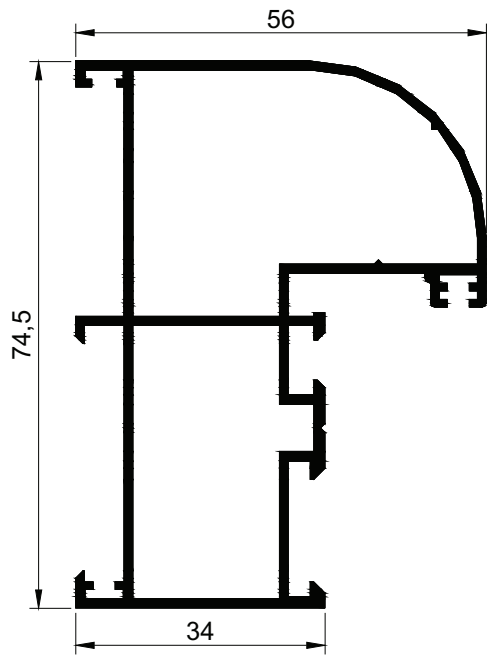

**3355**  $m = 1,097 \text{ kg/m}$

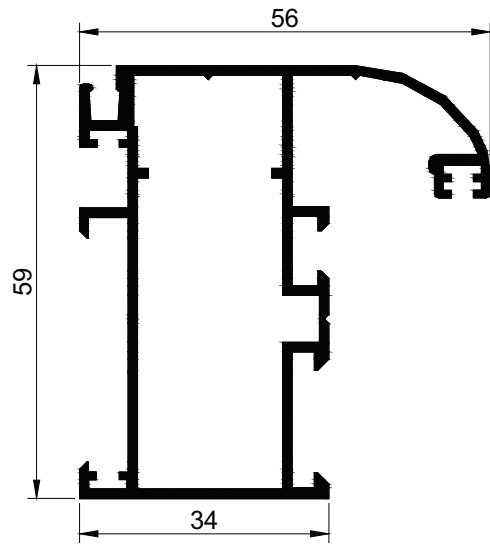

**3361**  $m = 0,973 \text{ kg/m}$

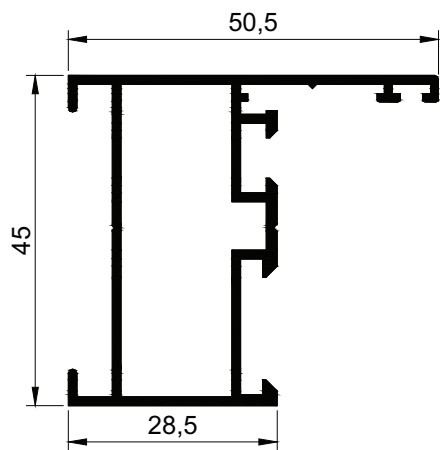

**3622**  $m = 0,679 \text{ kg/m}$

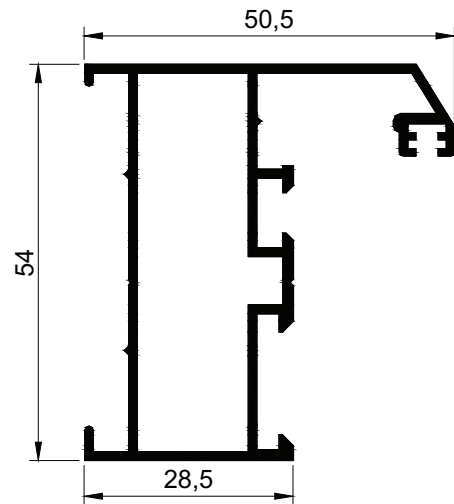

**3693**  $m = 0,768 \text{ kg/m}$

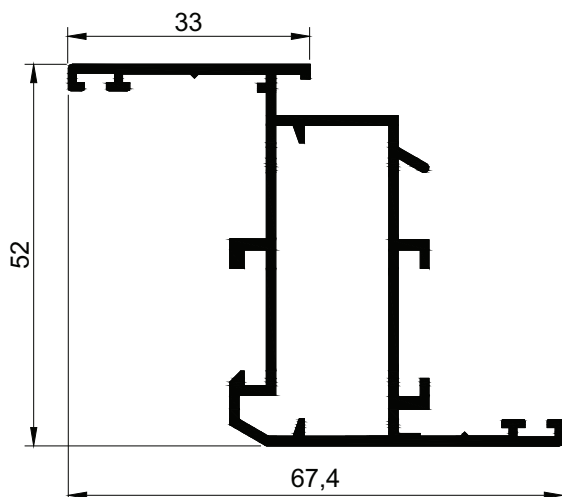

**3623**  $m = 0,823 \text{ kg/m}$

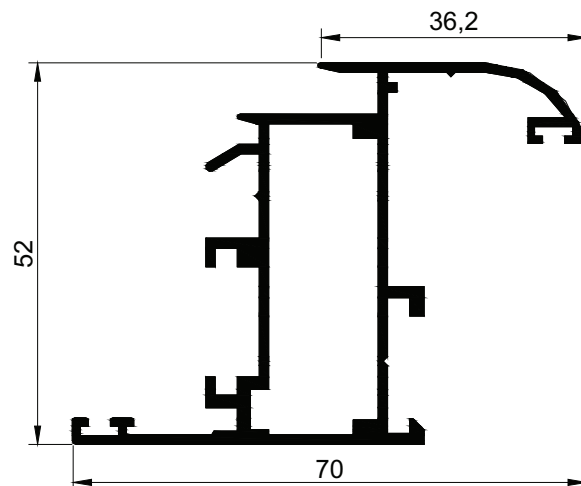

**3360**  $m = 0,953 \text{ kg/m}$

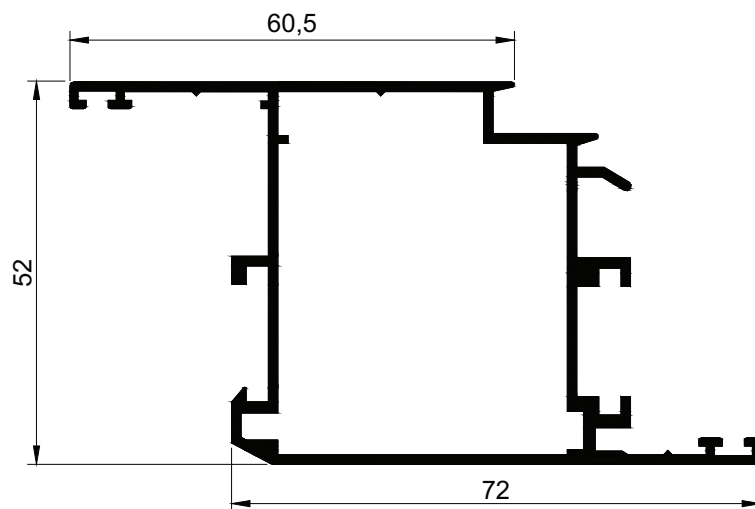

**3698** m = 1,110 kg/m

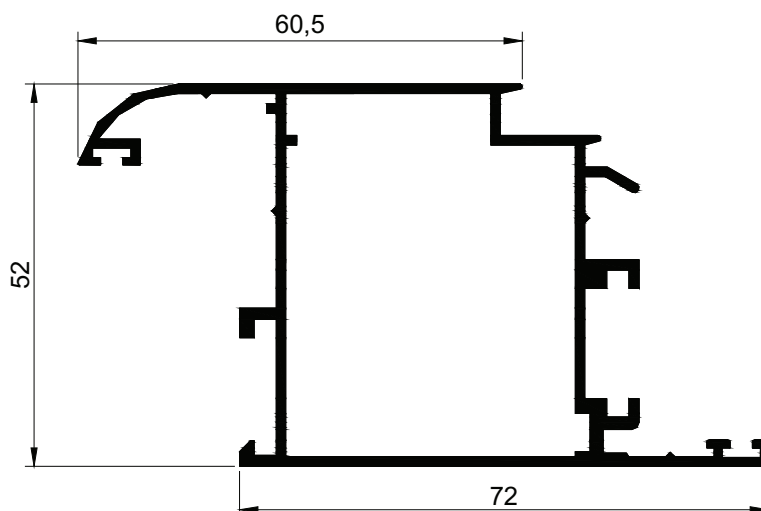

**3420** m = 1,202 kg/m

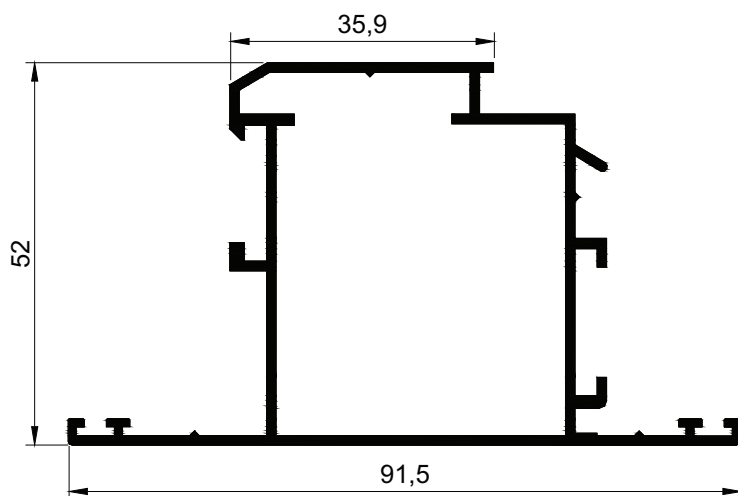

**3421** m = 1,089 kg/m

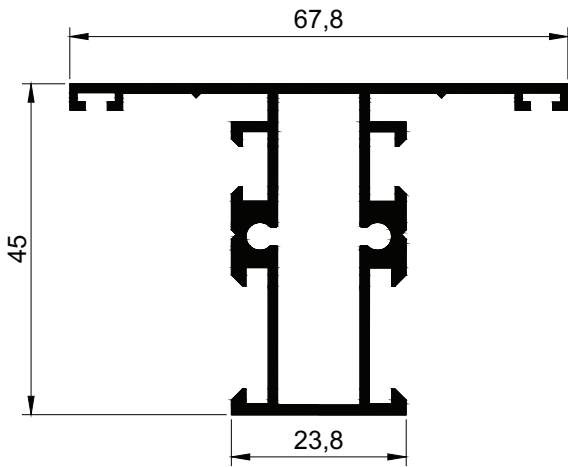

**3362**  $m = 0,891 \text{ kg/m}$

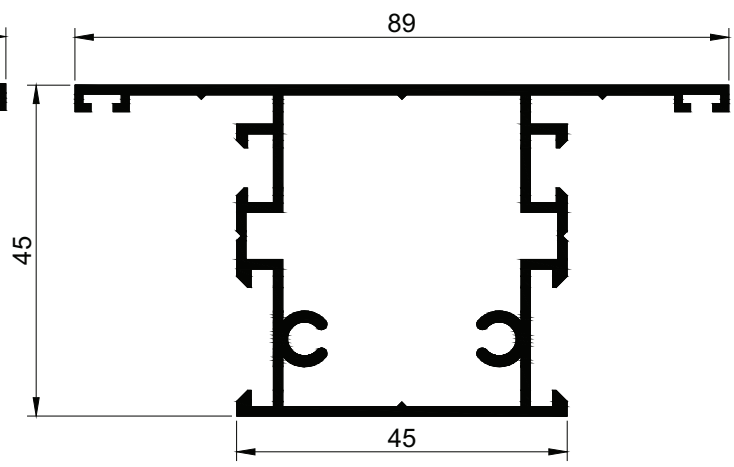

**3422**  $m = 1,174 \text{ kg/m}$

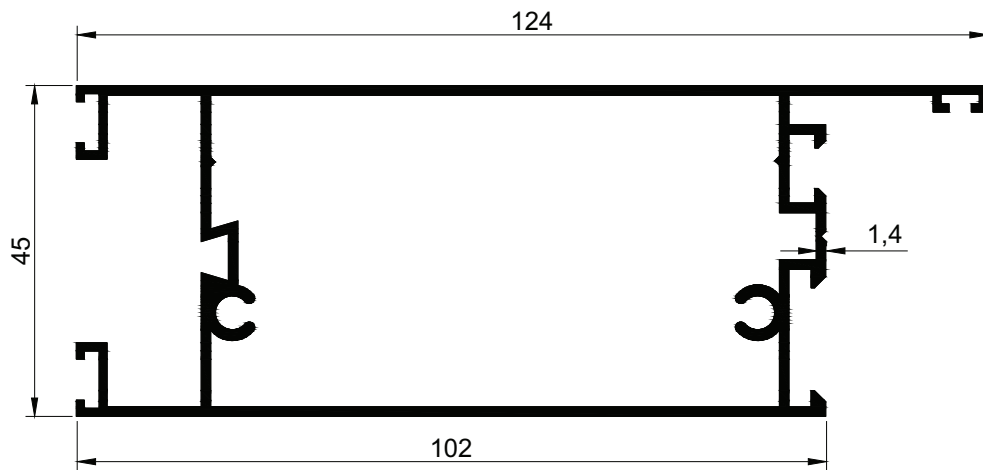

**3424**  $m = 1,675 \text{ kg/m}$

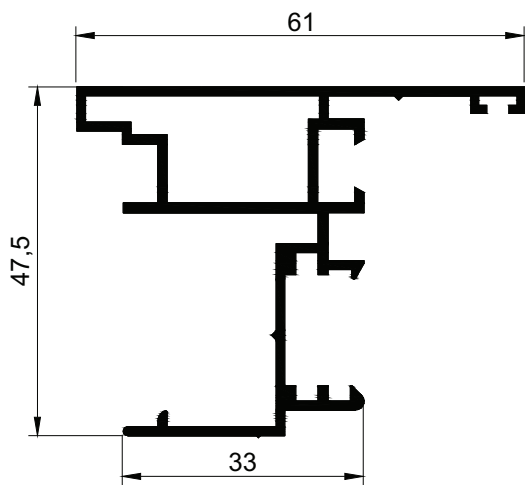

**3552**  $m = 0,830 \text{ kg/m}$

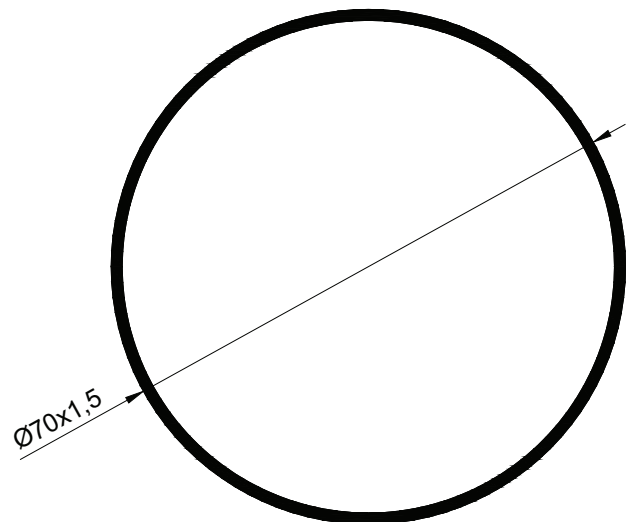

**3434**  $m = 0,874 \text{ kg/m}$

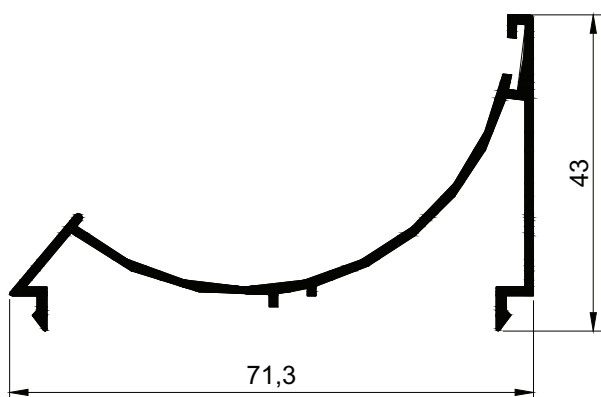
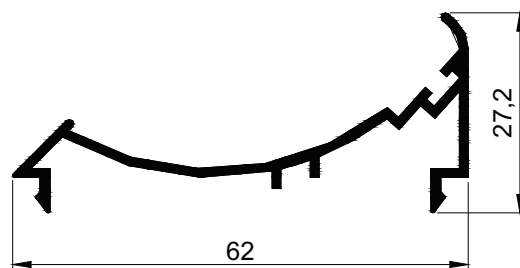
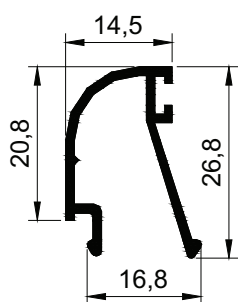
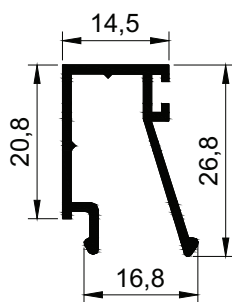
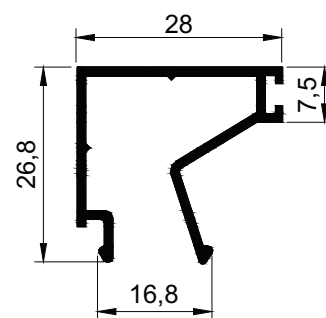
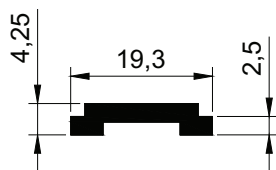
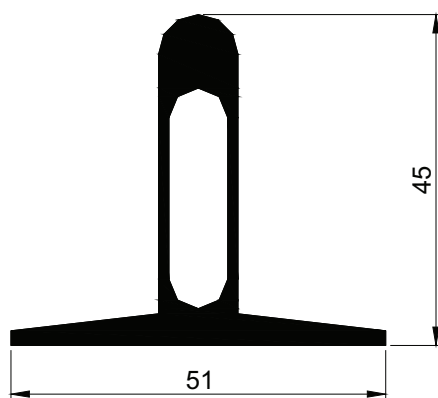
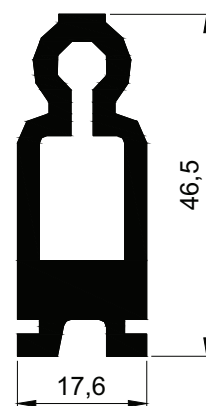
**3433**  $m = 0,584 \text{ kg/m}$ 

**3555**  $m = 0,440 \text{ kg/m}$ 

**3357**  $m = 0,250 \text{ kg/m}$ 

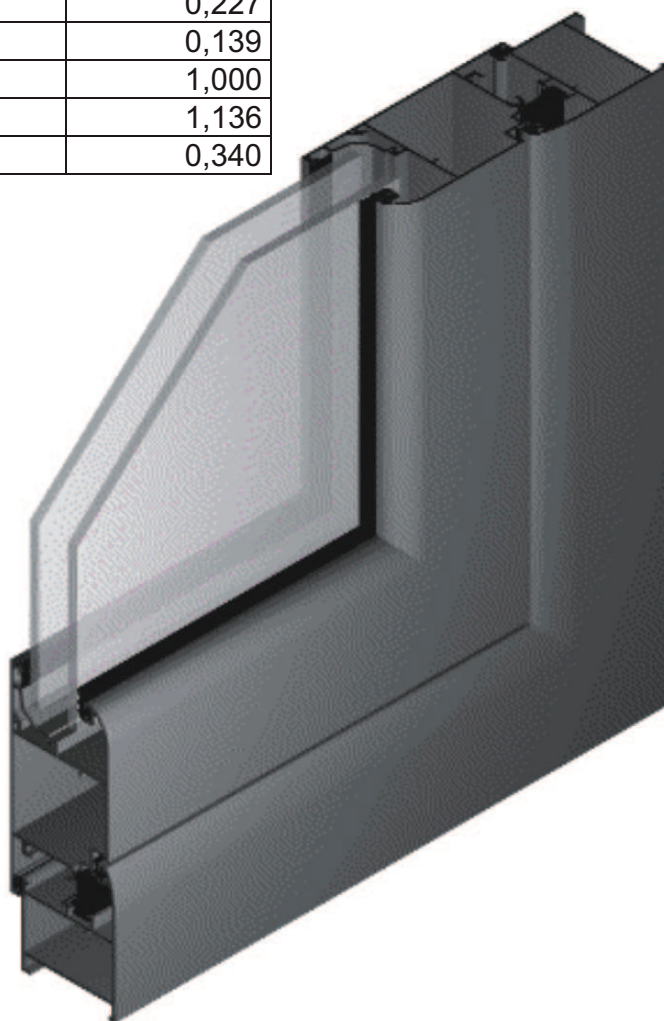
**3419**  $m = 0,249 \text{ kg/m}$ 

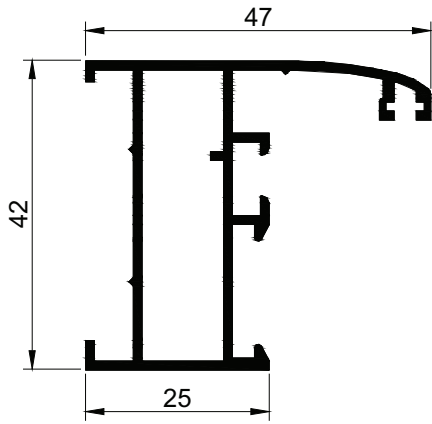
**3399**  $m = 0,328 \text{ kg/m}$ 

**3550**  $m = 0,139 \text{ kg/m}$ 

**3528**  $m = 1,000 \text{ kg/m}$ 

**3418**  $m = 1,136 \text{ kg/m}$



Cod	Denumire profil	kg / m
3696	Toc rotund mic	0,632
3815	Toc rotund mare	0,699
3701	Cercevea rotund mic	0,734
3700	Cercevea rotund mare	0,956
3814	Teu usa exterioara	0,956
3694	Teu mare	0,948
3813	Teu greu	1,409
3695	Teu mic	0,762
3812	Plinta usa	1,445
3699	Adaptor	0,748
3811	Colt 90°	0,500
3810	Colt 45°	0,458
3301	Teava Ø50x1,7	0,800
3805	Profil colt	0,312
3806	Aparatoare apa	0,166
3807	Bagheta	0,269
3697	Bagheta	0,227
3550	Sina	0,139
3528	Piesa legatura	1,000
3418	Piesa legatura	1,136
3830	Prag usa	0,340





**3696**  $m = 0,632 \text{ kg/m}$

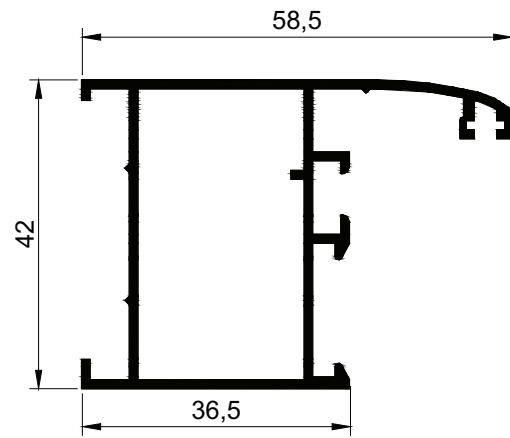

**3815**  $m = 0,699 \text{ kg/m}$

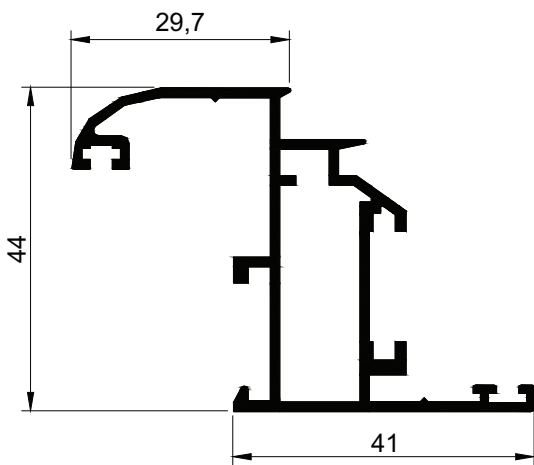

**3701**  $m = 0,734 \text{ kg/m}$

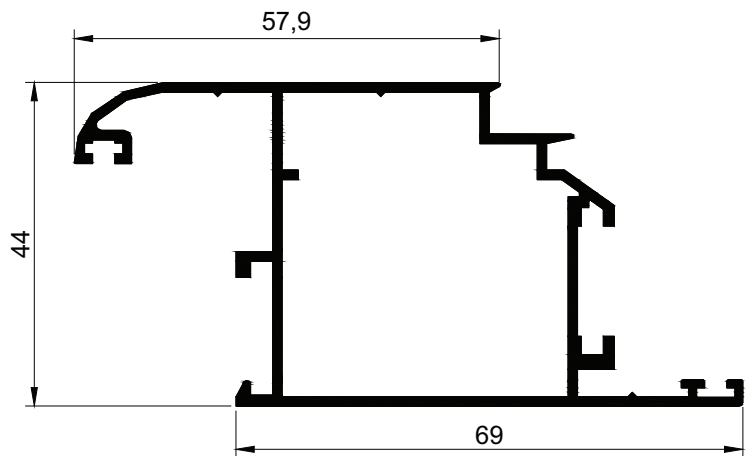

**3700**  $m = 0,956 \text{ kg/m}$

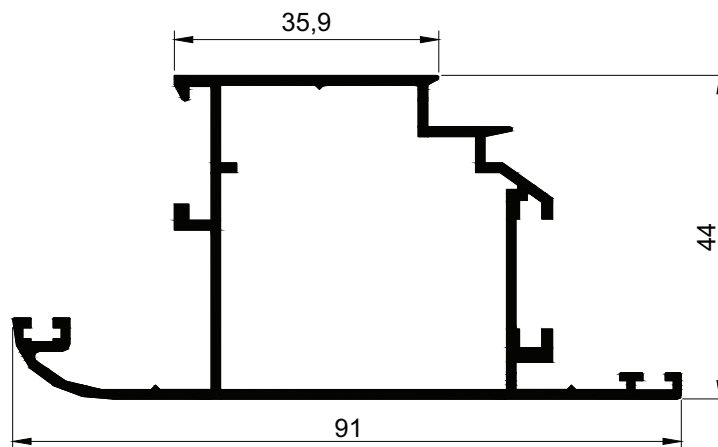

**3814**  $m = 0,956 \text{ kg/m}$



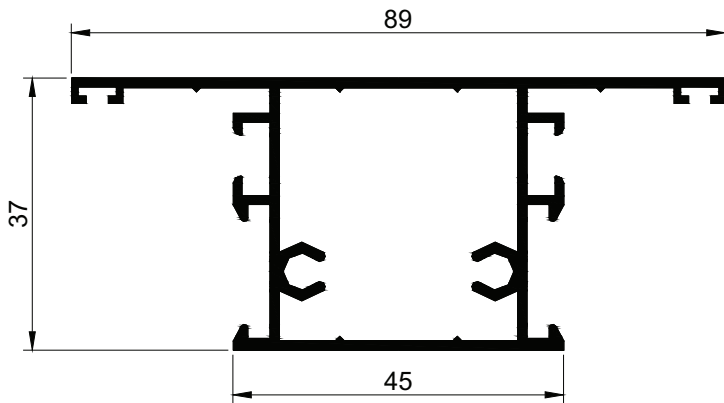

**3694**  $m = 0,948 \text{ kg/m}$

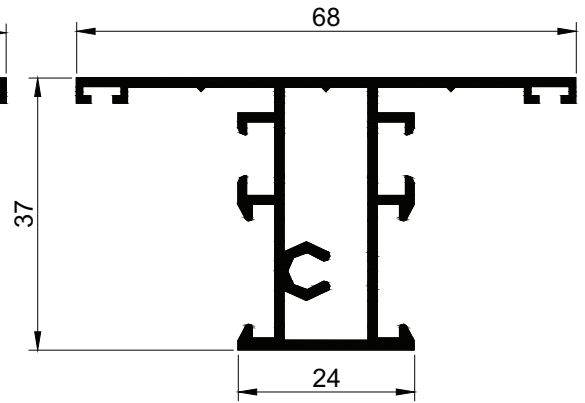

**3695**  $m = 0,762 \text{ kg/m}$

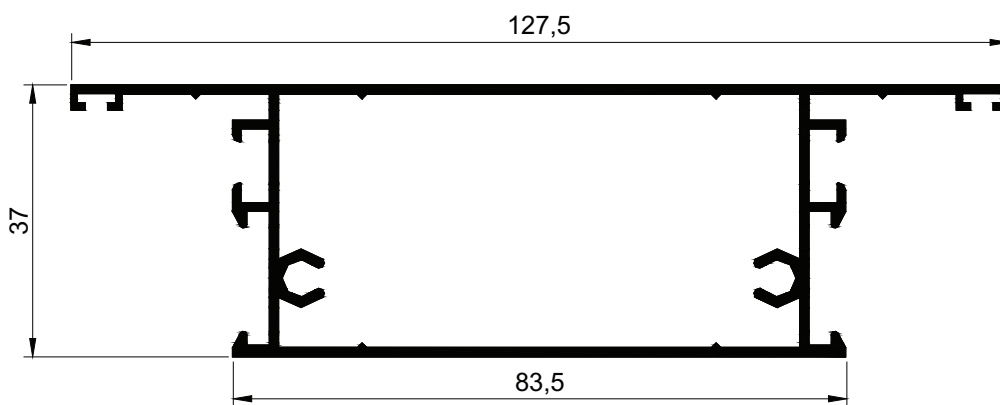

**3813**  $m = 1,409 \text{ kg/m}$

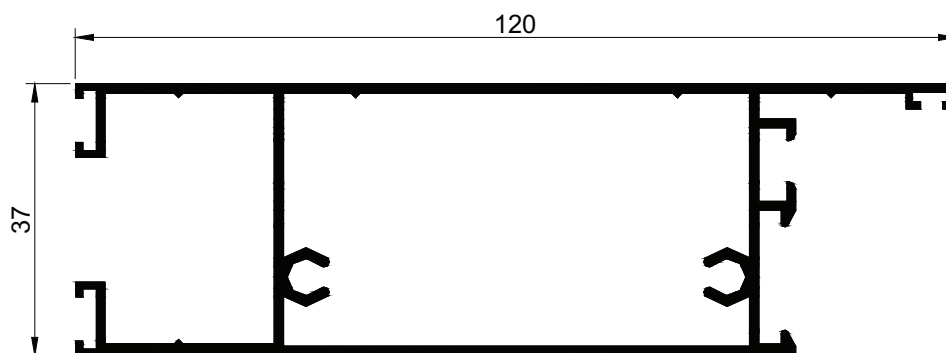

**3812**  $m = 1,445 \text{ kg/m}$

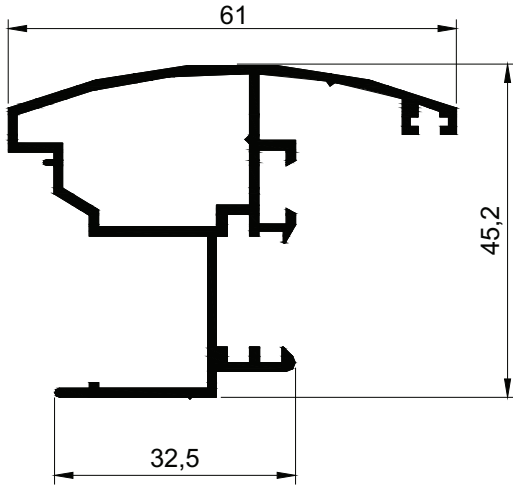

**3699**  $m = 0,748 \text{ kg/m}$

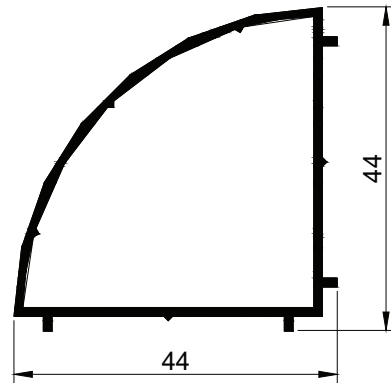

**3811**  $m = 0,500 \text{ kg/m}$

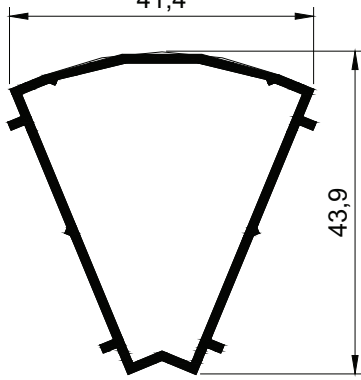

**3810**  $m = 0,458 \text{ kg/m}$

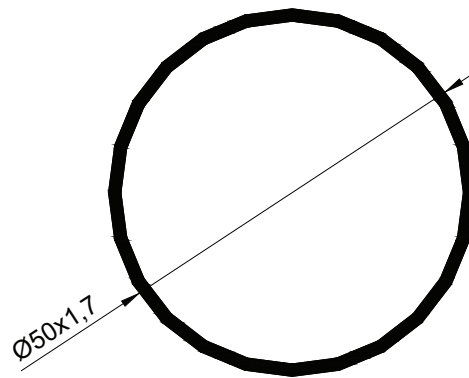

**3301**  $m = 0,800 \text{ kg/m}$

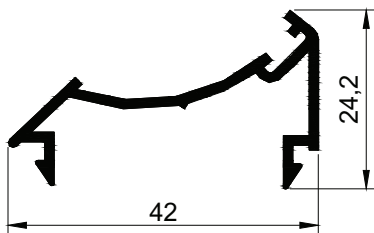

**3805**  $m = 0,312 \text{ kg/m}$

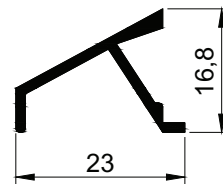

**3806**  $m = 0,166 \text{ kg/m}$

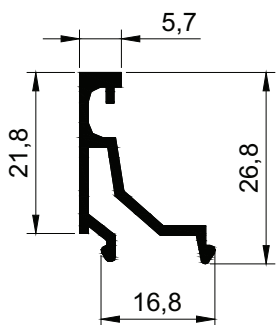
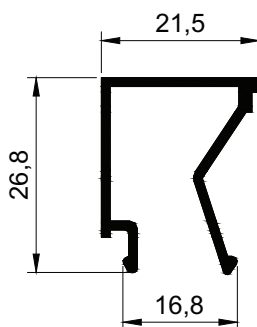
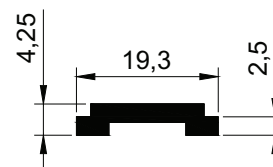
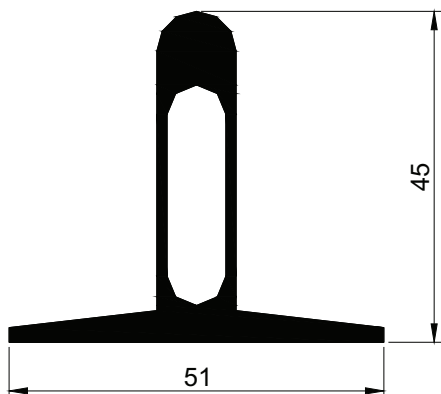
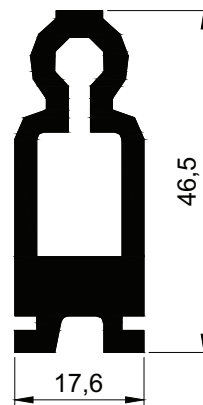
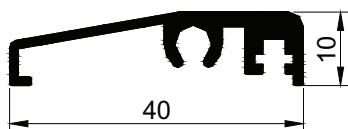
**3697**  $m = 0,227 \text{ kg/m}$ 

**3807**  $m = 0,269 \text{ kg/m}$ 

**3550**  $m = 0,139 \text{ kg/m}$ 

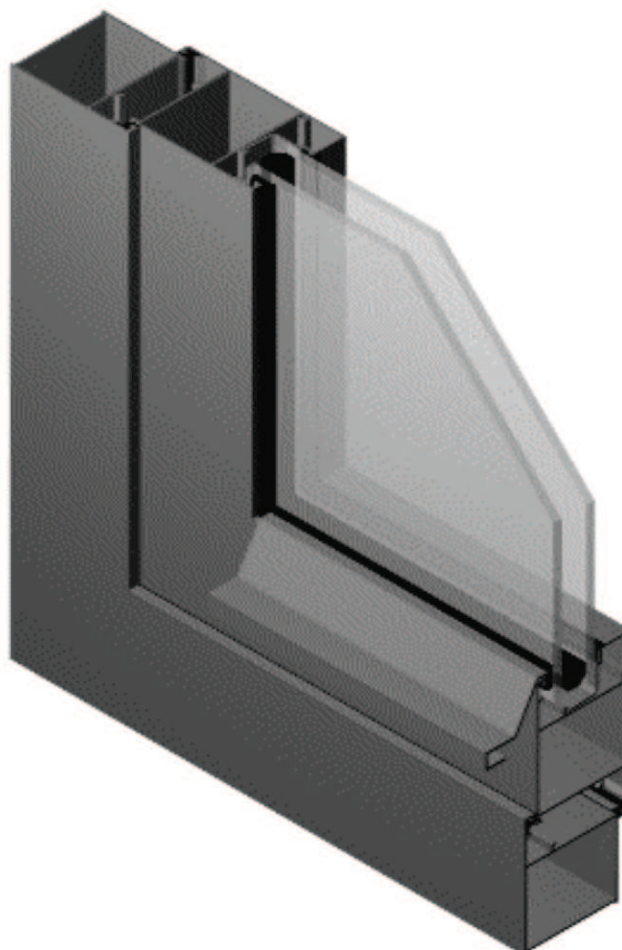
**3528**  $m = 1,000 \text{ kg/m}$ 

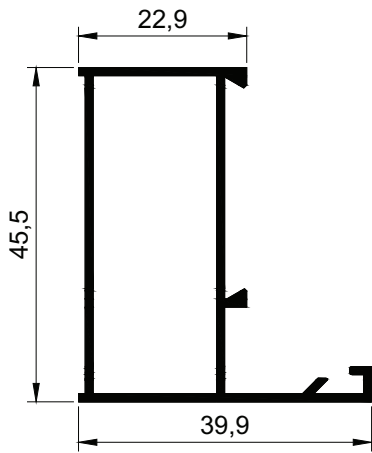
**3418**  $m = 1,136 \text{ kg/m}$ 

**3830**  $m = 0,340 \text{ kg/m}$



Cod	Denumire profil	kg / m
3080	Toc mic	0,536
3079	Cercevea mica	0,656
3078	Teu mic	0,656
3073	Toc mare	0,650
3075	Cercevea mare	0,777
3074	Teu mare	0,777
3038	Teu lat	1,117
3045	Cercevea lata	1,117
3069	Plinta usa	1,137
3908	Montant colt	0,777
3007	Bagheta termopan	0,245
3009	Bagheta normala	0,246
3010	Lambriu dublu	0,619
3012	Lambriu simplu	0,365
3047	Aparatoare apa	0,206
3066A	Coltar mare	1,169
3066B	Coltar mijlociu	1,093
3105	Sina exterioara	0,131
3106	Sina interioara	0,138
3151A	Profil U mare	0,699
3151B	Profil U mijlociu	0,555





**3080** m = 0,536 kg/m

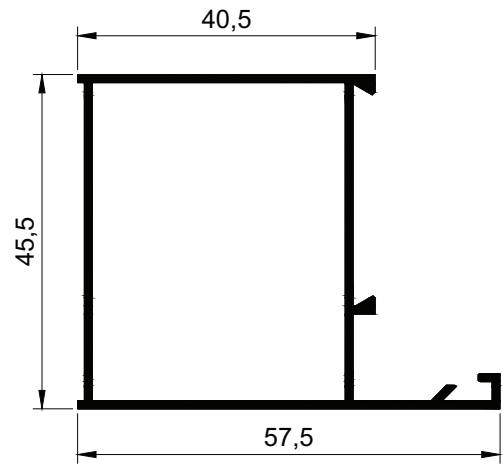

**3073** m = 0,650 kg/m

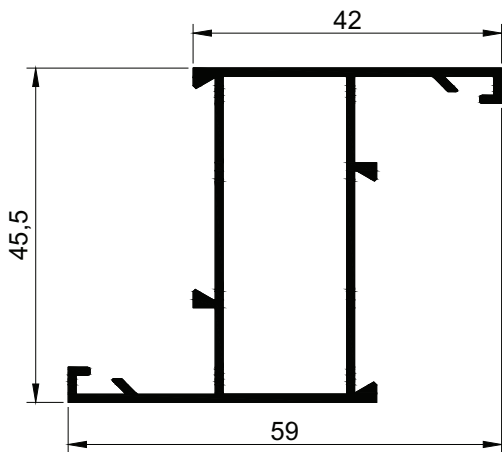

**3079** m = 0,656 kg/m

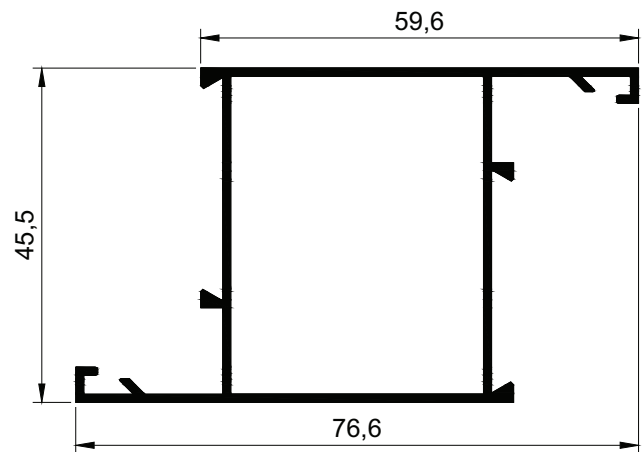

**3075** m = 0,771 kg/m

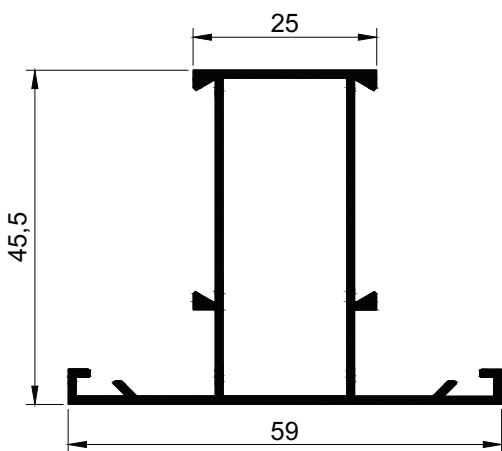

**3078** m = 0,656 kg/m

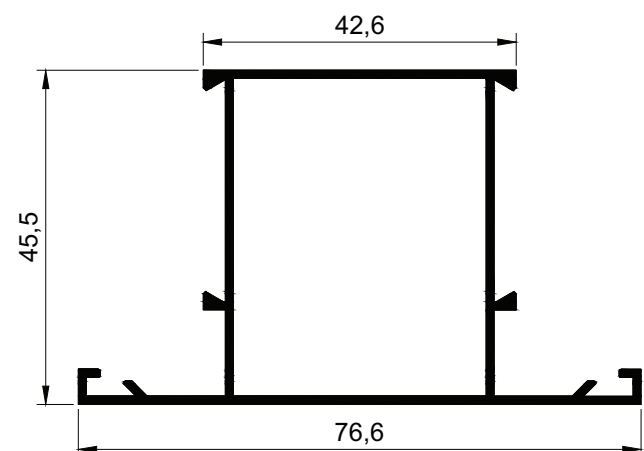

**3074** m = 0,771 kg/m

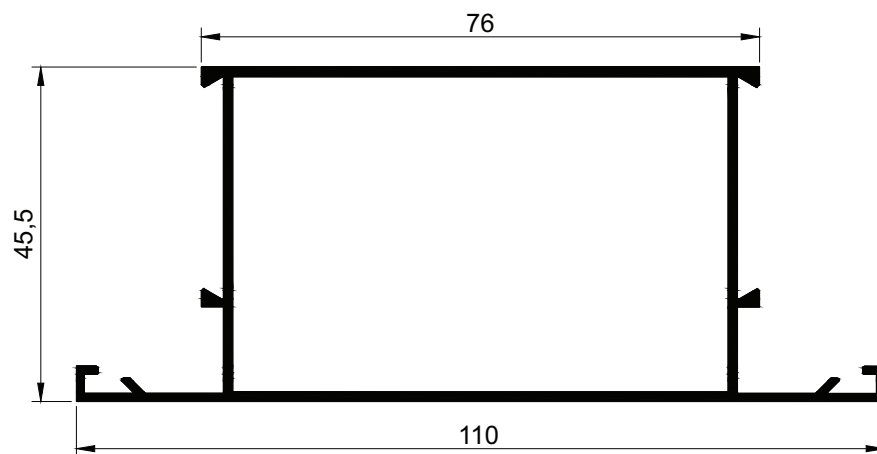

**3038**  $m = 1,117 \text{ kg/m}$

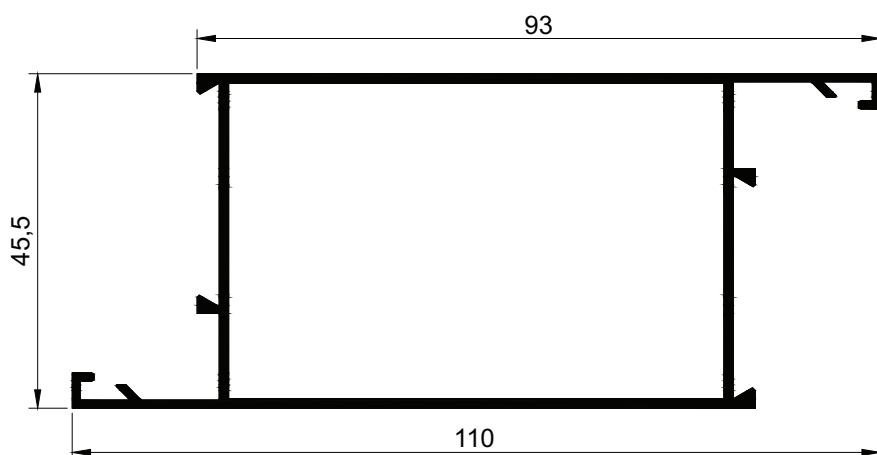

**3045**  $m = 1,117 \text{ kg/m}$

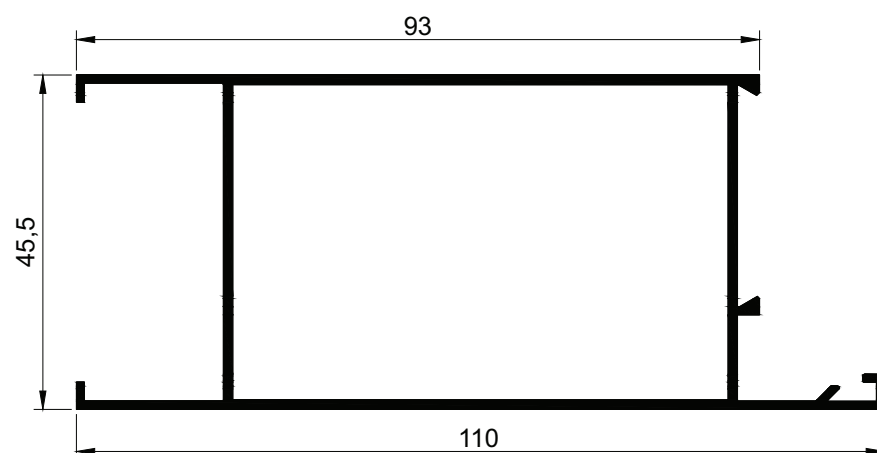

**3069**  $m = 1,137 \text{ kg/m}$

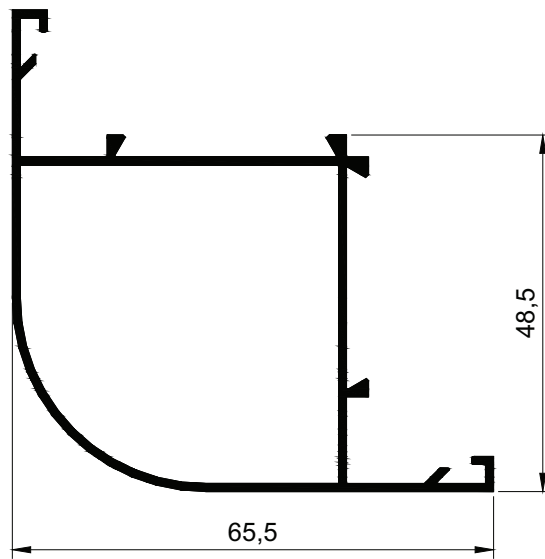

**3908** m = 0,777 kg/m

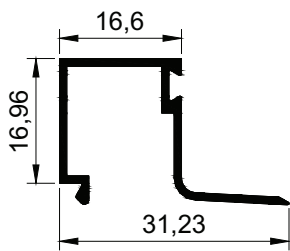

**3007** m = 0,245 kg/m

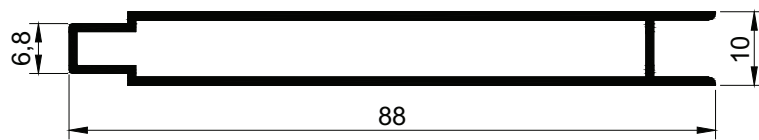

**3010** m = 0,614 kg/m

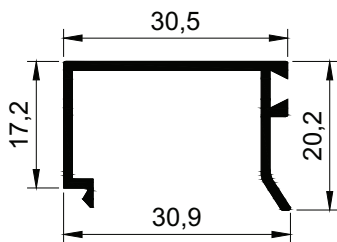

**3009** m = 0,246 kg/m

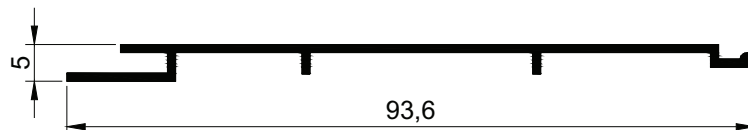

**3012** m = 0,365 kg/m



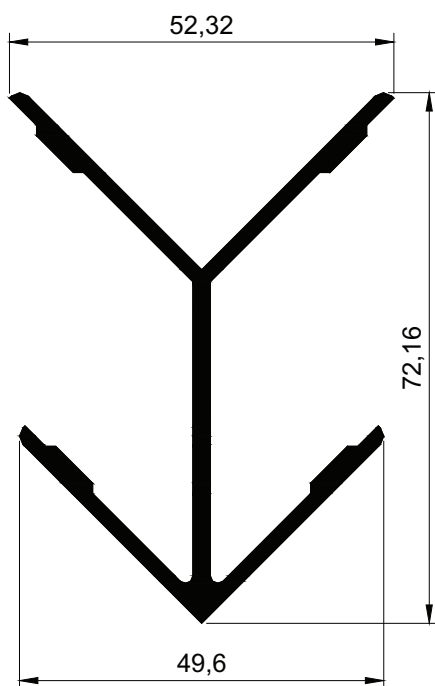

**3066A**  $m = 1,169 \text{ kg/m}$

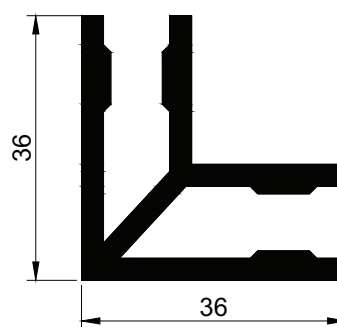

**3066B**  $m = 1,093 \text{ kg/m}$

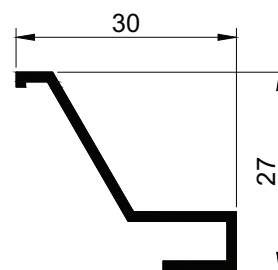

**3047**  $m = 0,206 \text{ kg/m}$

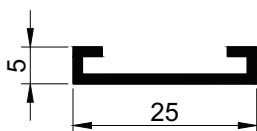

**3105**  $m = 0,131 \text{ kg/m}$

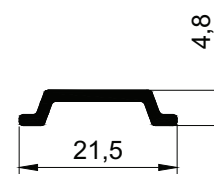

**3106**  $m = 0,138 \text{ kg/m}$

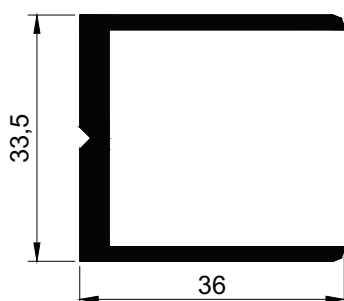

**3151A**  $m = 0,699 \text{ kg/m}$

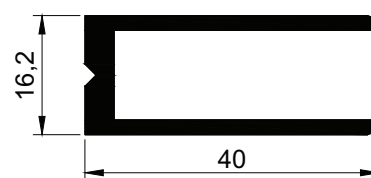

**3151B**  $m = 0,555 \text{ kg/m}$



Cod	Denumire profil	kg / m
Glisant mare		
3020	Rama	0,715
3021	Toc	0,680
3028	Teu	0,631
3023	Capac	0,267
3026	Sina	0,119
3024	Ornament	0,180
3025	Bagheta	0,195
3022	Adaptor	0,413
3027	Capac S	0,289
3066C	Coltar mic	0,751
3151C	Profil U mic	0,444
Glisant mic		
3370	Toc	0,675
3371	Rama	0,690
3372	Rama	0,710
3373	Rama	0,670
3374	Capac	0,285
3375	Bagheta geam simplu	0,185
3376	Rama dreapta	0,676
3377	Adaptor	0,179
3378	Toc simplu	0,473

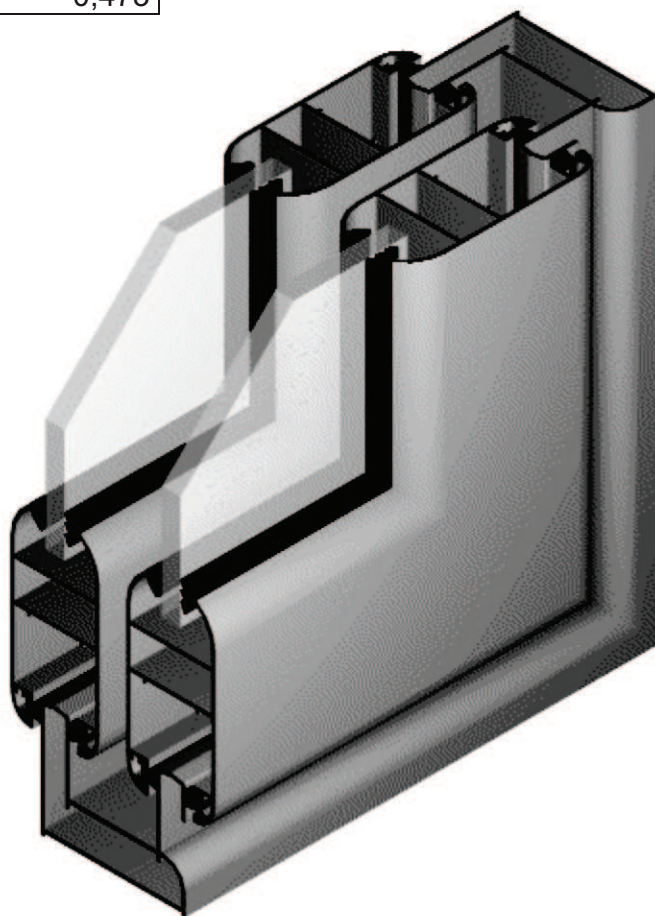

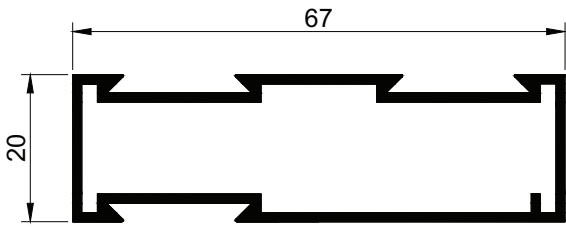
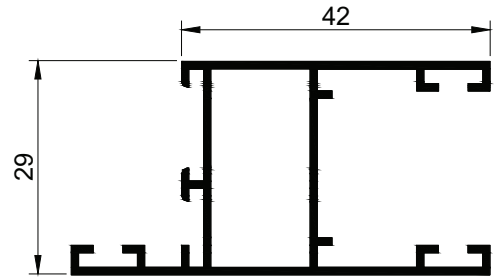
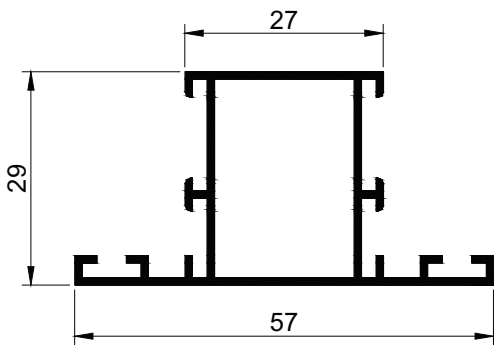
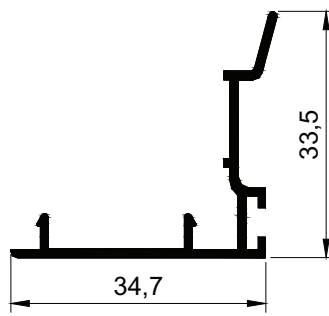
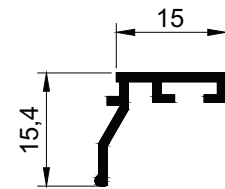
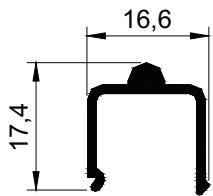
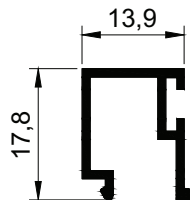
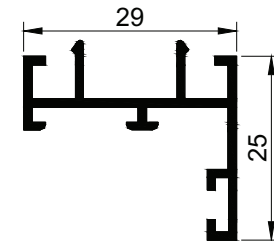
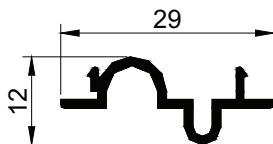
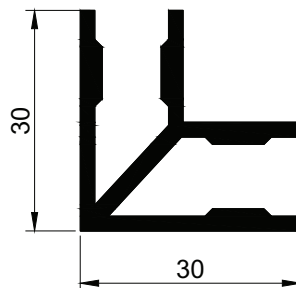
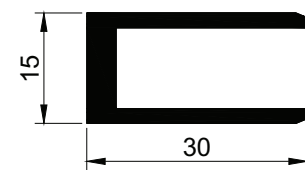

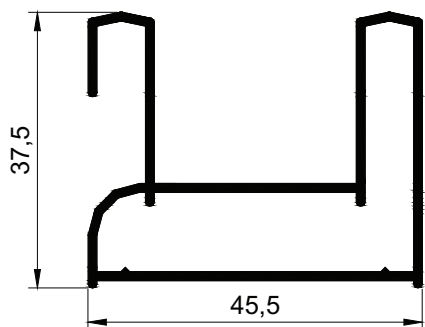
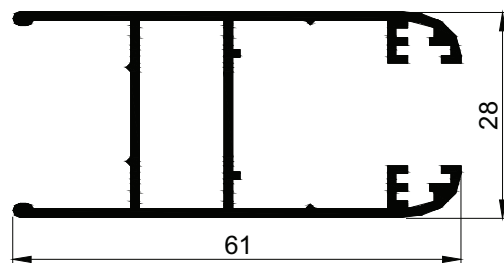
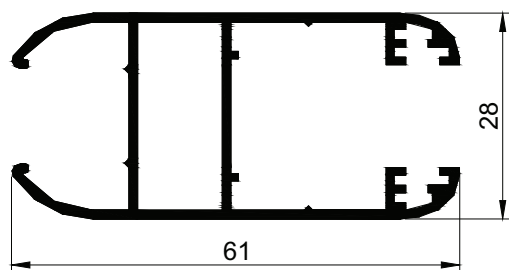
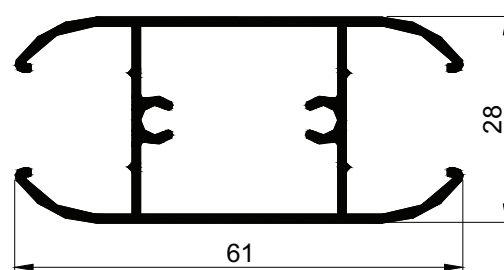
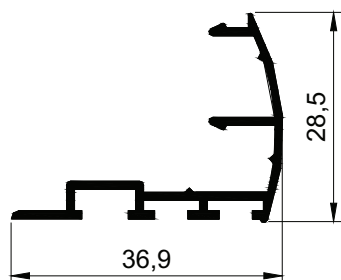
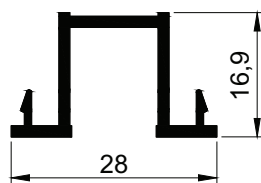
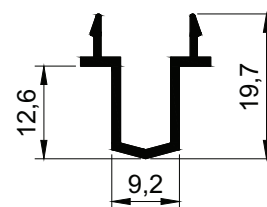
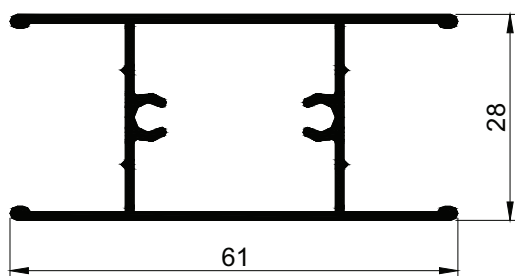
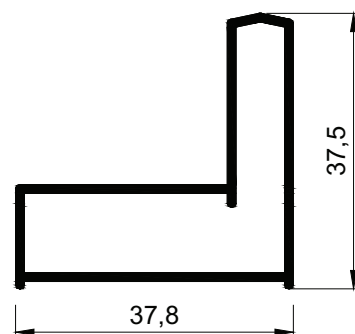
**3020**  $m = 0,715 \text{ kg/m}$ 

**3021**  $m = 0,680 \text{ kg/m}$ 

**3028**  $m = 0,631 \text{ kg/m}$ 

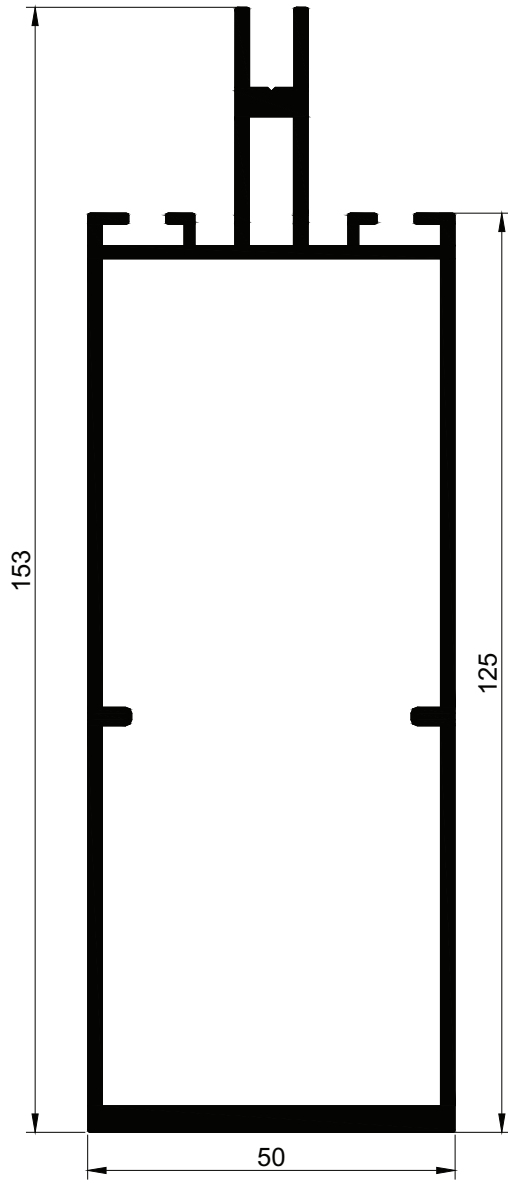
**3023**  $m = 0,267 \text{ kg/m}$ 

**3026**  $m = 0,119 \text{ kg/m}$ 

**3024**  $m = 0,180 \text{ kg/m}$ 

**3025**  $m = 0,195 \text{ kg/m}$ 

**3022**  $m = 0,413 \text{ kg/m}$ 

**3027**  $m = 0,289 \text{ kg/m}$ 

**3066C**  $m = 0,751 \text{ kg/m}$ 

**3151C**  $m = 0,444 \text{ kg/m}$



**3370**  $m = 0,675 \text{ kg/m}$ 

**3371**  $m = 0,690 \text{ kg/m}$ 

**3372**  $m = 0,710 \text{ kg/m}$ 

**3373**  $m = 0,670 \text{ kg/m}$ 

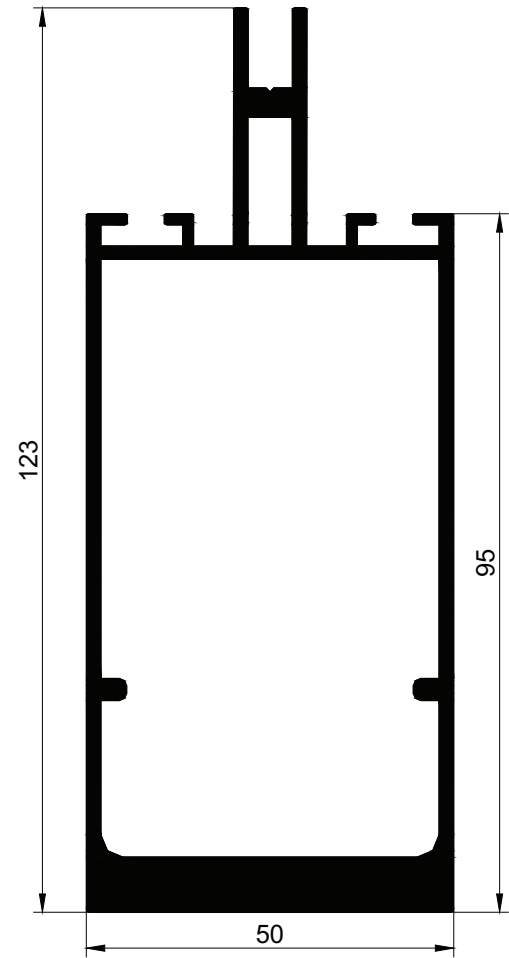
**3374**  $m = 0,285 \text{ kg/m}$ 

**3375**  $m = 0,185 \text{ kg/m}$ 

**3377**  $m = 0,179 \text{ kg/m}$ 

**3376**  $m = 0,676 \text{ kg/m}$ 

**3378**  $m = 0,473 \text{ kg/m}$



<b>Cod</b>	<b>Denumire profil</b>	<b>kg / m</b>
2061	Montant greu	2,572
2062	Montant mare	2,745
2063	Montant mijlociu	1,801
2064	Montant mic	1,426
2065	Capac fixare	0,473
2066	Capac fixare	0,569
2067	Capac mascare	0,385
2068	Capac mascare	0,438
2069	Adaptor	0,624
2070	Profil imbinare	0,851
2071	Adaos	0,252



**2061** m = 2,572 kg/m



**2062** m = 2,745 kg/m

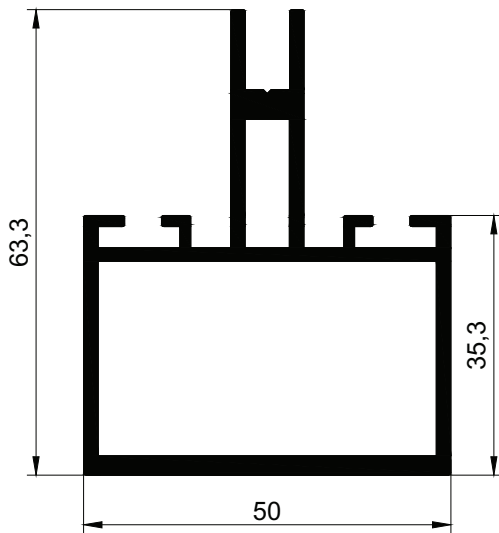

**2064** m = 1,426 kg/m

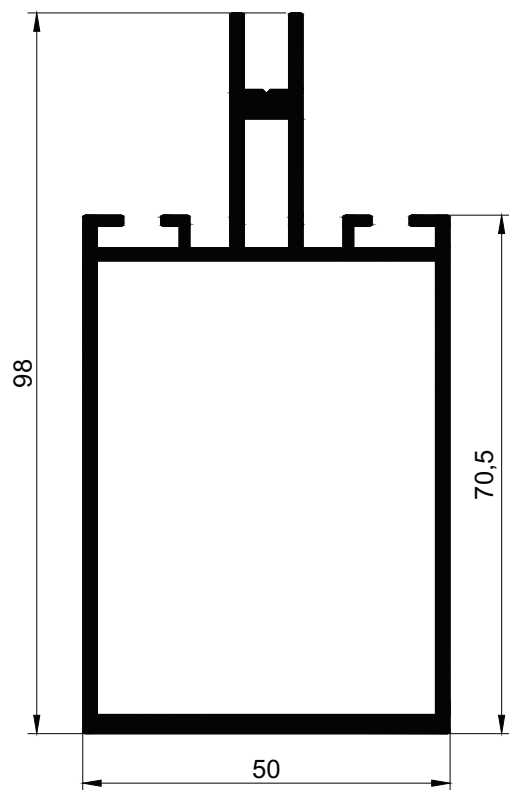

**2063** m = 1,801 kg/m



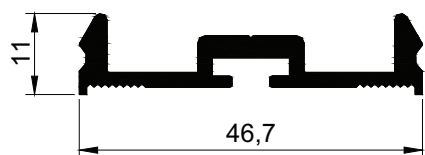

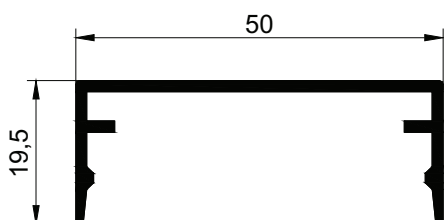
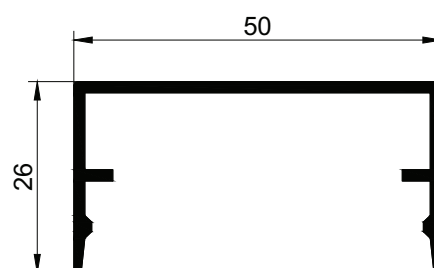
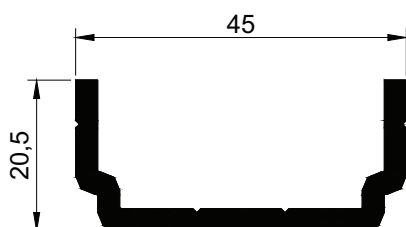
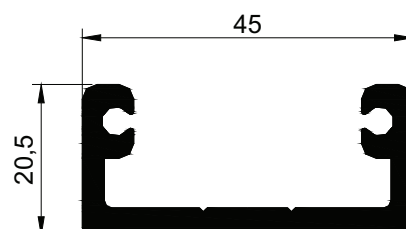
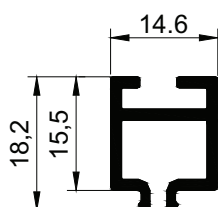
**2065**  $m = 0,473 \text{ kg/m}$ 

**2066**  $m = 0,569 \text{ kg/m}$ 

**2067**  $m = 0,385 \text{ kg/m}$ 

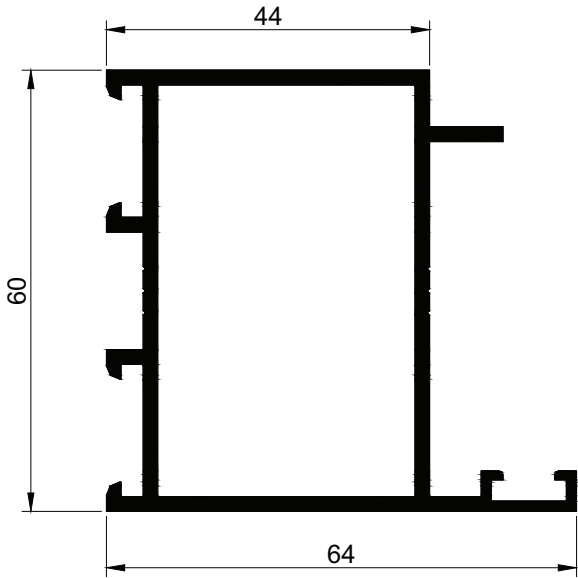
**2068**  $m = 0,438 \text{ kg/m}$ 

**2069**  $m = 0,624 \text{ kg/m}$ 

**2070**  $m = 0,851 \text{ kg/m}$ 

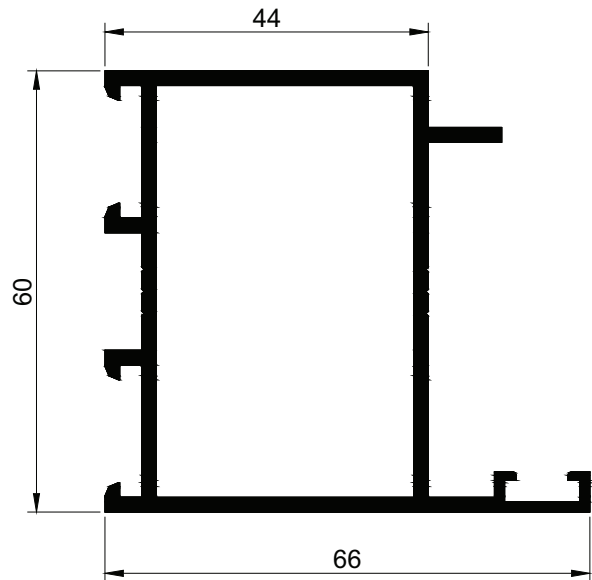
**2071**  $m = 0,252 \text{ kg/m}$



<b>Cod</b>	<b>Denumire profil</b>	<b>kg / m</b>
6001	Toc-cercevea	1,351
6002	Toc-cercevea	1,363
6003	Toc	1,479
6004	Teu mic	0,982
6005	Teu mediu	1,312
6006	Teu lat	1,842
6007	Teu grilaj	1,798
6008	Plinta	1,518
6009	Plinta lata	2,098
6010	Colt 135	1,146
6011	Colt 90	1,354
6012	Adaptor	1,014
6013	Adaptor	0,609
6014	Adaptor	0,418
6015	Adaptor aripa	0,217
6016	Adaptor usa batanta	0,460
6017	Adaptor usa batanta	0,398
6018	Bagheta	0,249
6019	Bagheta	0,268
6020	Bagheta	0,338
6021	Piesa imbinare	1,126
6022	Contraplaca broasca	0,473
6023	Contraplaca broasca	0,534
6024	Balama	1,674
6025	Capac balama	0,471
6026	Balama	2,749
6027	Capac balama	0,610
6028	Coltar	9,806
6029	Coltar	6,161



**6001**  $m = 1,351 \text{ kg/m}$



**6002**  $m = 1,363 \text{ kg/m}$

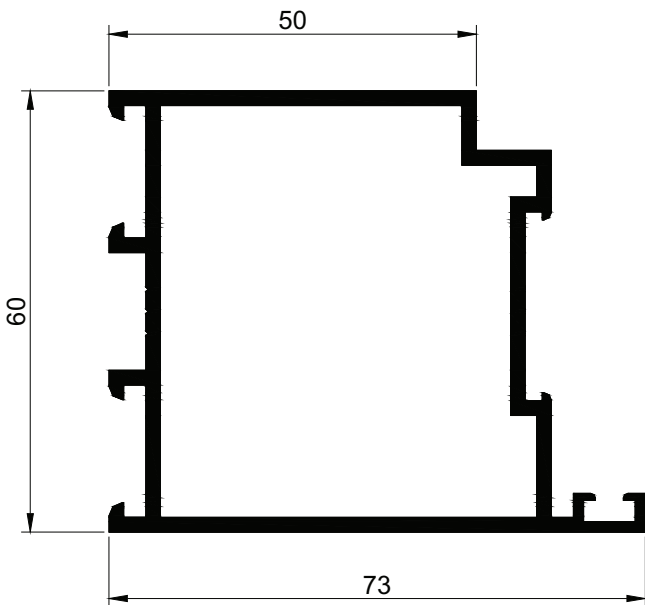

**6003**  $m = 1,479 \text{ kg/m}$

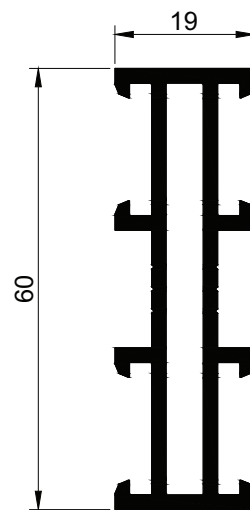

**6004**  $m = 0,982 \text{ kg/m}$

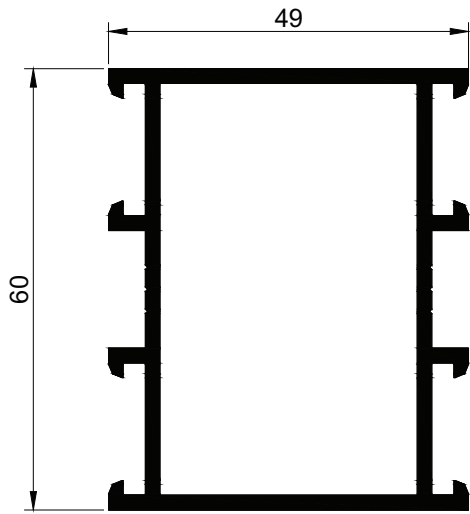

**6005**     $m = 1,312 \text{ kg/m}$

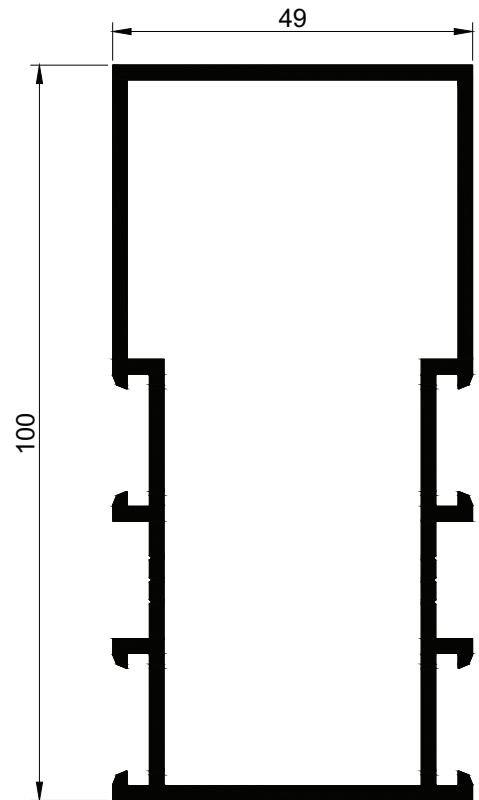

**6007**     $m = 1,798 \text{ kg/m}$

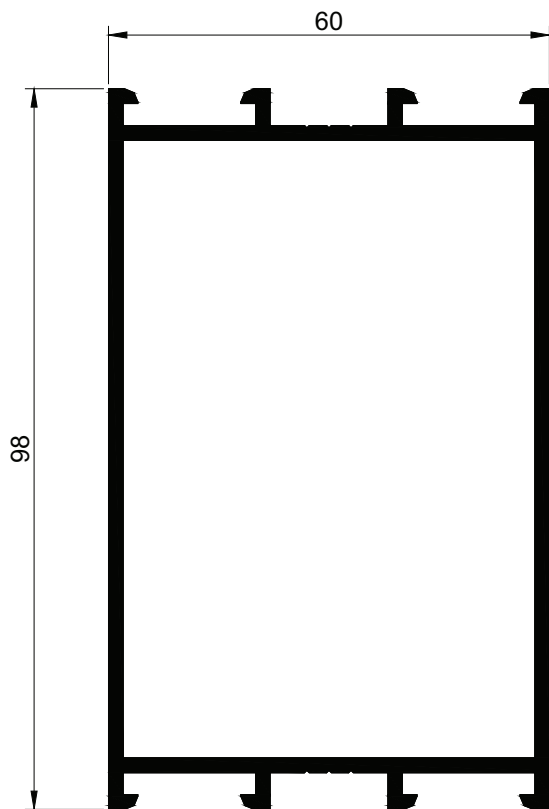

**6006**     $m = 1,842 \text{ kg/m}$

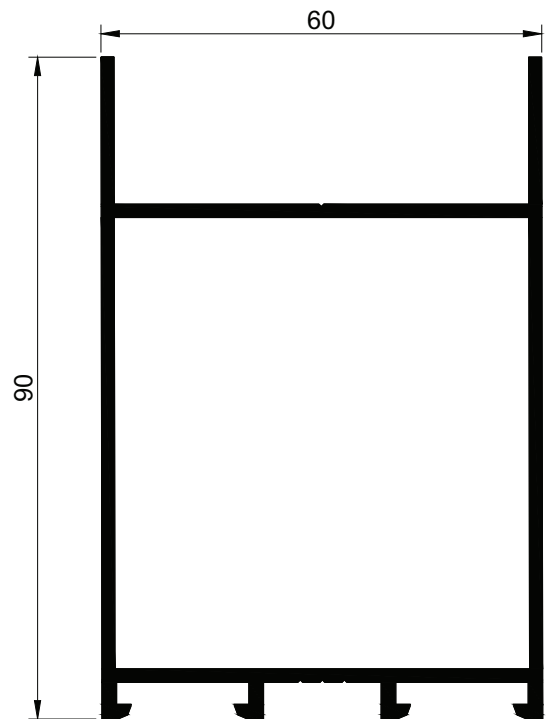

**6008**     $m = 1,518 \text{ kg/m}$

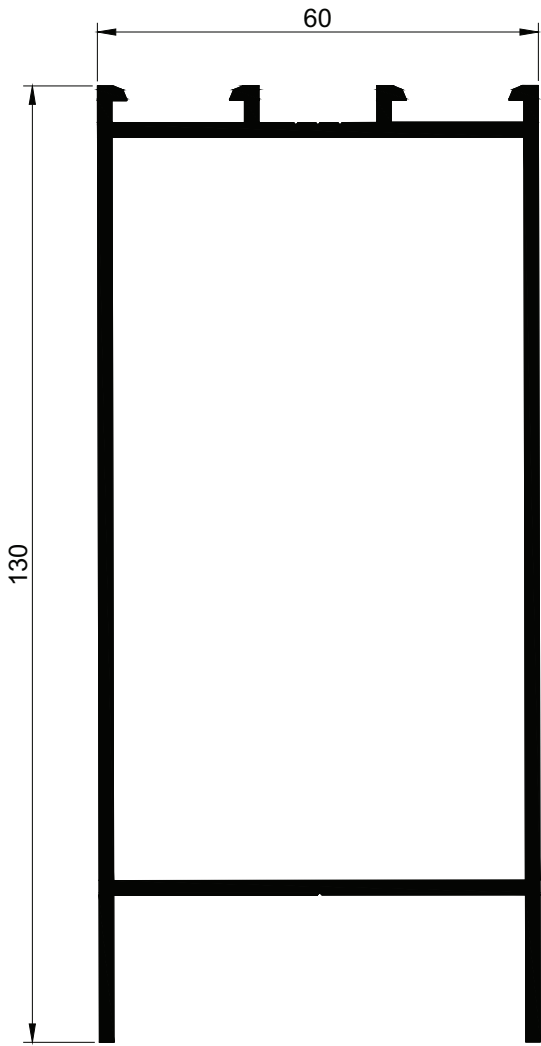

**6009**  $m = 2,098 \text{ kg/m}$

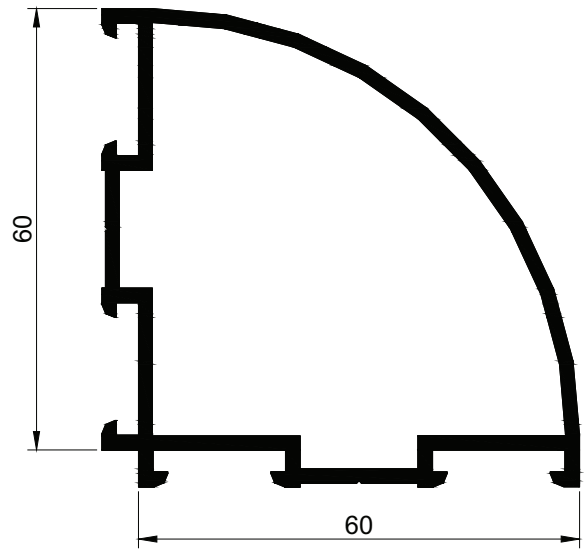

**6011**  $m = 1,354 \text{ kg/m}$

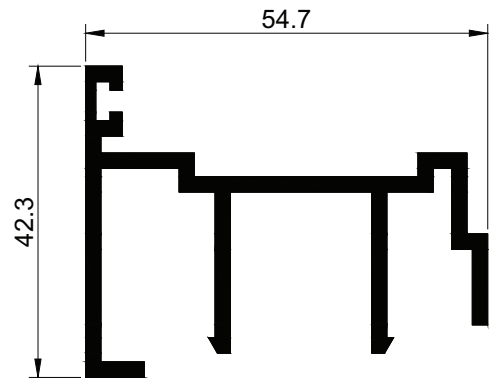

**6012**  $m = 1,014 \text{ kg/m}$

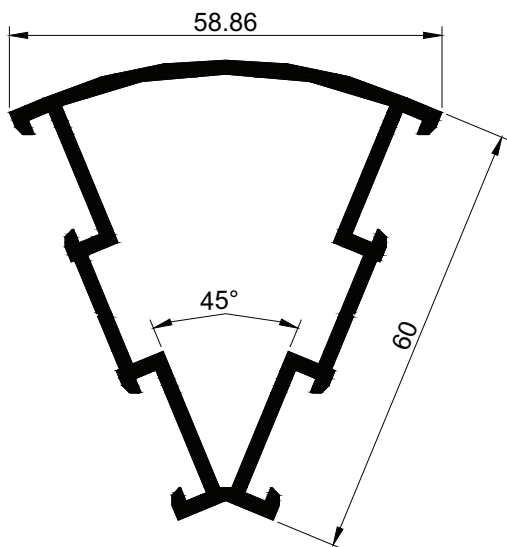

**6010**  $m = 1,146 \text{ kg/m}$

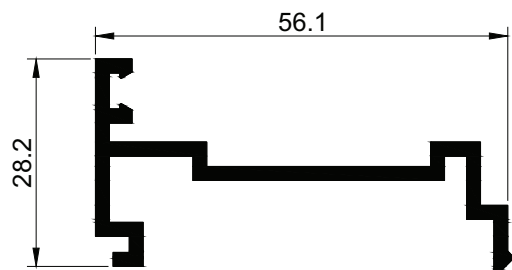

**6013**  $m = 0,609 \text{ kg/m}$

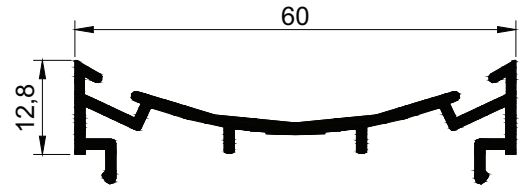
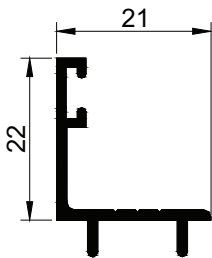
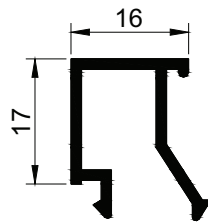
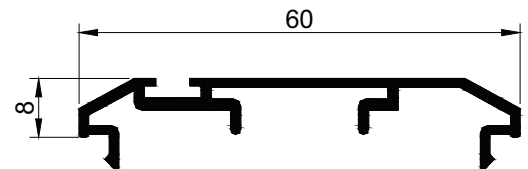
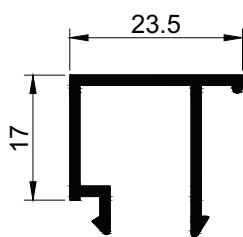
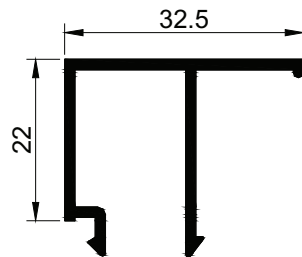
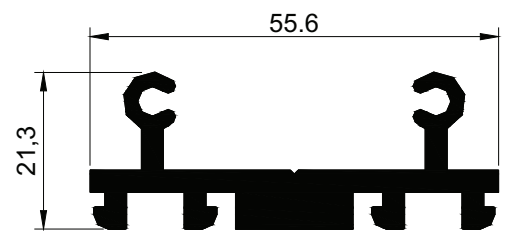
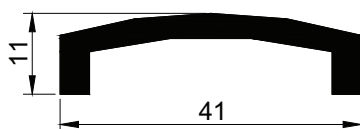
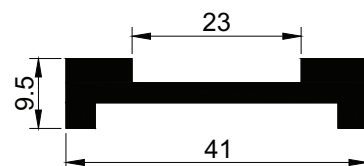
**6014**  $m = 0,418 \text{ kg/m}$ 

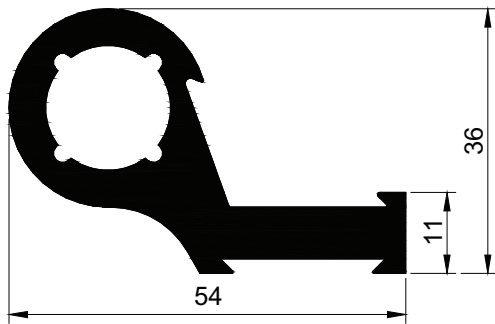
**6016**  $m = 0,460 \text{ kg/m}$ 

**6015**  $m = 0,217 \text{ kg/m}$ 

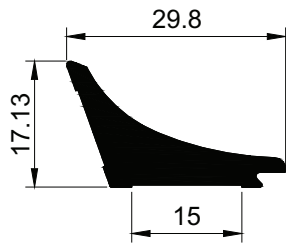
**6018**  $m = 0,249 \text{ kg/m}$ 

**6017**  $m = 0,398 \text{ kg/m}$ 

**6019**  $m = 0,268 \text{ kg/m}$ 

**6020**  $m = 0,338 \text{ kg/m}$ 

**6021**  $m = 1,126 \text{ kg/m}$ 

**6022**  $m = 0,473 \text{ kg/m}$ 

**6023**  $m = 0,534 \text{ kg/m}$



**6024** m = 1,674 kg/m



**6025** m = 0,471 kg/m



**6028** m = 9,806 kg/m

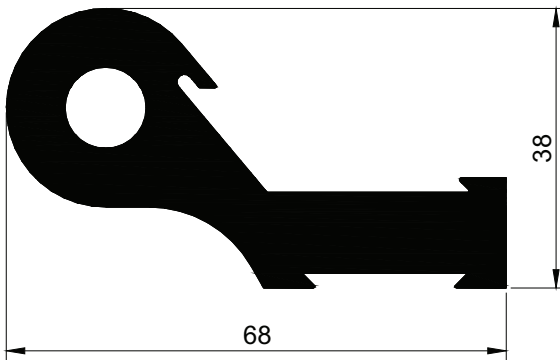

**6026** m = 2,749 kg/m

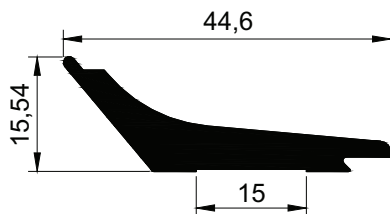

**6027** m = 0,610kg/m

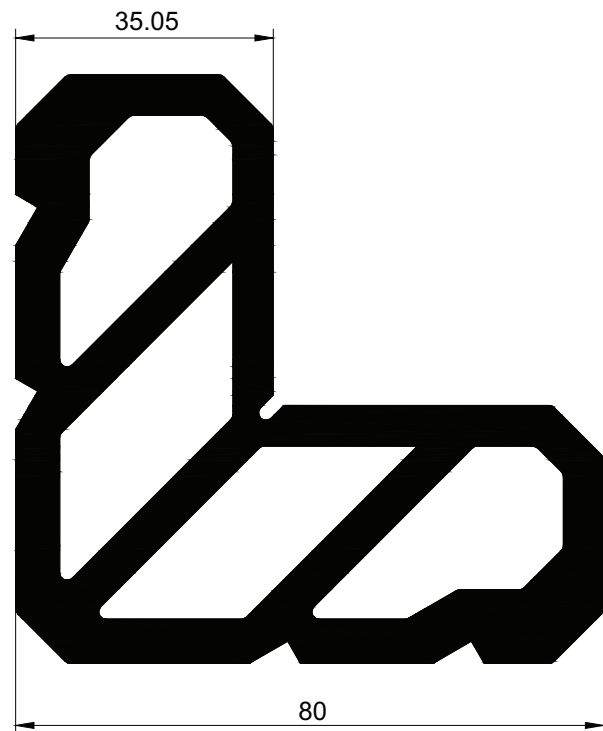

**6029** m = 6.161 kg/m



<b>Cod</b>	<b>Denumire profil</b>	<b>kg / m</b>
<b>3581</b>	Profil colt drept	0,606
<b>3314</b>	Profil colt rotund	0,398
<b>3313</b>	Profil drept	0,492
<b>3582</b>	Profil colt octogon	0,770

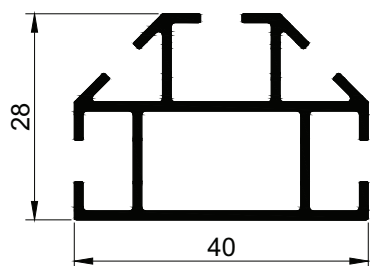

**3581** m = 0,606 kg/m

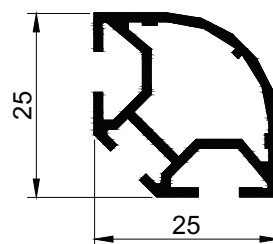

**3314** m = 0,398 kg/m

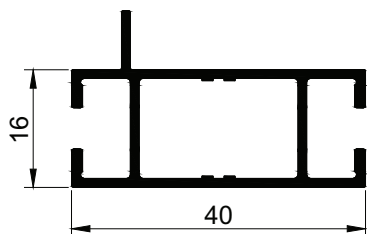

**3313** m = 0,492 kg/m

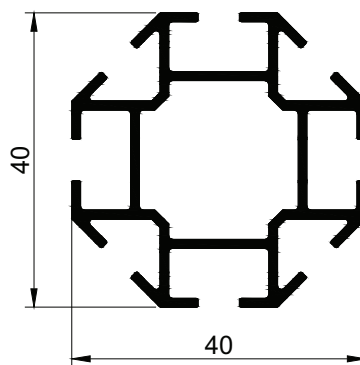

**3582** m = 0,770 kg/m

<b>Cod</b>	<b>Denumire profil</b>	<b>kg / m</b>
<b>Profile pentru rama insecte</b>		
<b>3115</b>	Rama mare	0,279
<b>3116</b>	Rama mica	0,213
<b>Profile ornament</b>		
<b>3067</b>	Ornament 20	0,306
<b>3068</b>	Capac ornament 20	0,106
<b>3013</b>	Ornament 50	0,530
<b>3081</b>	Capac ornament 50	0,271
<b>Profile pentru reclama</b>		
<b>3112</b>	Rama reclama	0,519
<b>3113</b>	Rama fata	0,188
<b>3114</b>	Rama spate	0,221
<b>3117</b>	Rama reclama mare	0,948
<b>Profile de completare</b>		
<b>3118</b>	Masca interior	0,343
<b>3119</b>	Glaf 165	0,957
<b>3120</b>	Glaf 135	0,735
<b>3121</b>	Glaf 195	1,206
<b>3122</b>	Glaf 105	0,617
<b>3123</b>	Glaf 75	0,503
<b>2020</b>	Lambriu	0,834

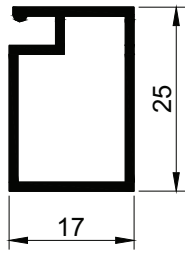
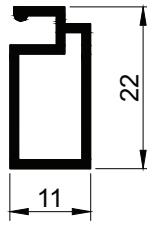
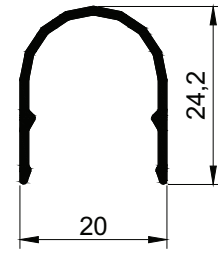
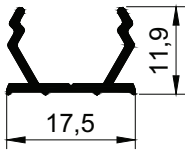
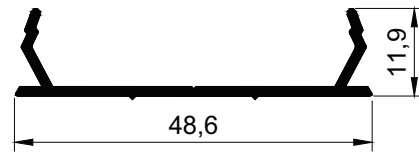
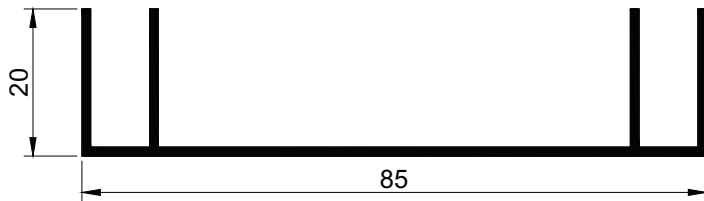
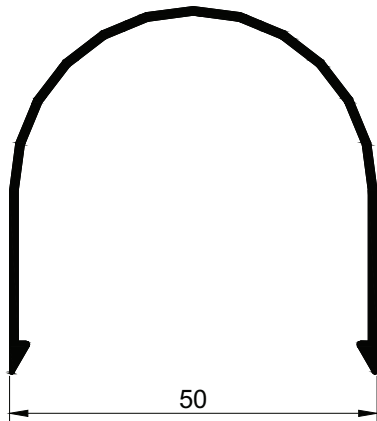
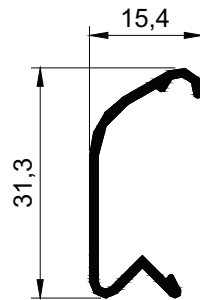
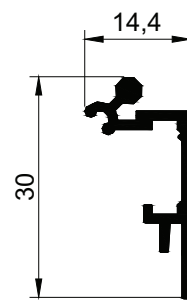
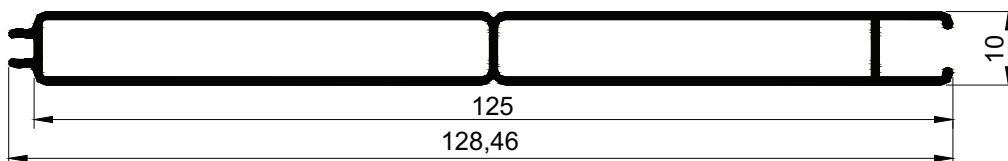

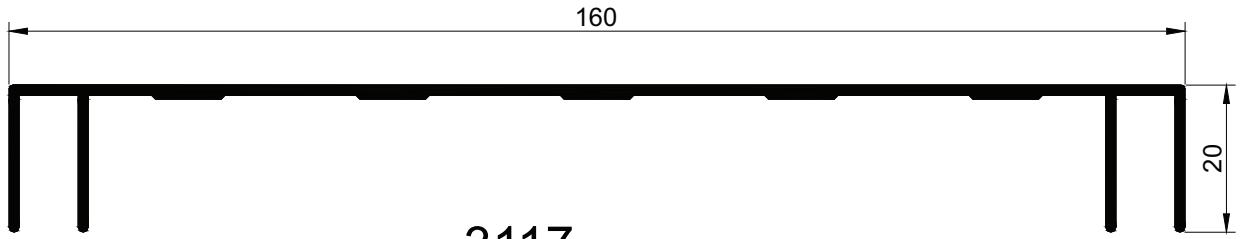
**3115**  $m = 0,279 \text{ kg/m}$ 

**3116**  $m = 0,213 \text{ kg/m}$ 

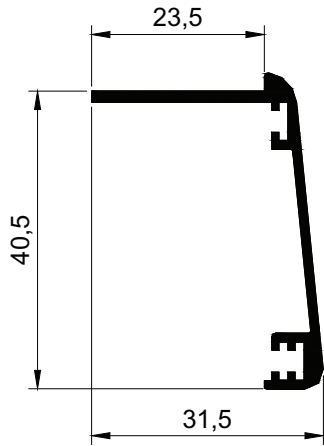
**3067**  $m = 0,306 \text{ kg/m}$ 

**3068**  $m = 0,106 \text{ kg/m}$ 

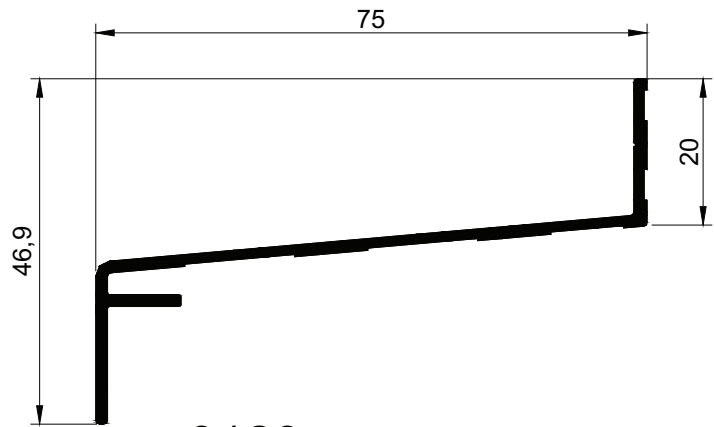
**3081**  $m = 0,271 \text{ kg/m}$ 

**3112**  $m = 0,519 \text{ kg/m}$ 

**3013**  $m = 0,530 \text{ kg/m}$ 

**3113**  $m = 0,188 \text{ kg/m}$ 

**3114**  $m = 0,221 \text{ kg/m}$ 

**2020**  $m = 0,834 \text{ kg/m}$



**3117**  $m = 0,948 \text{ kg/m}$



**3118**  $m = 0,343 \text{ kg/m}$



**3123**  $m = 0,503 \text{ kg/m}$

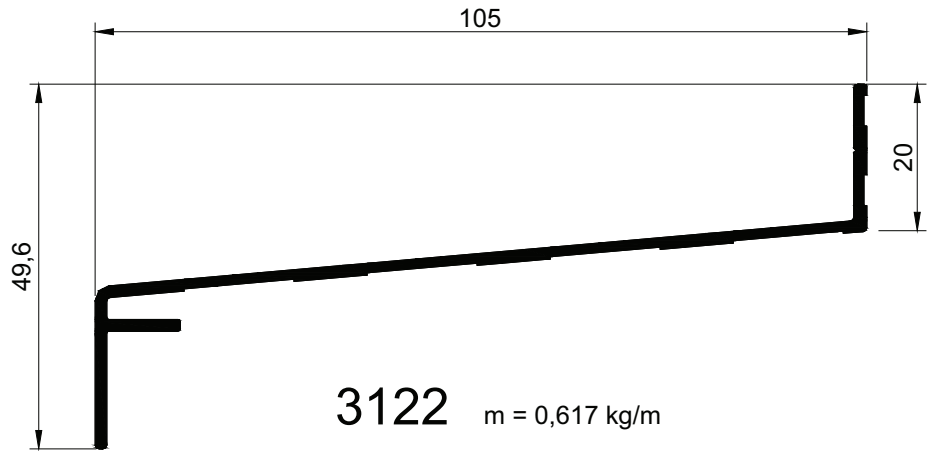

**3122**  $m = 0,617 \text{ kg/m}$

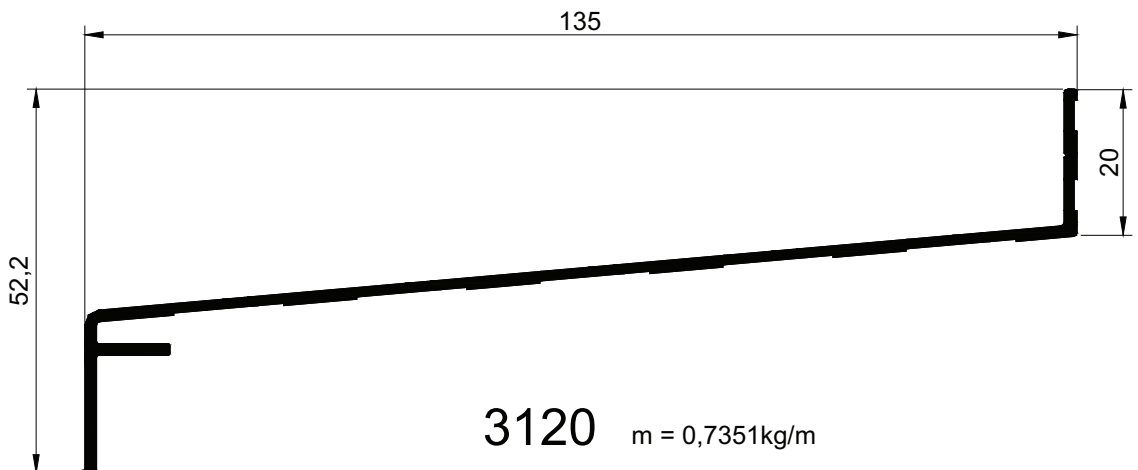

**3120**  $m = 0,7351 \text{ kg/m}$

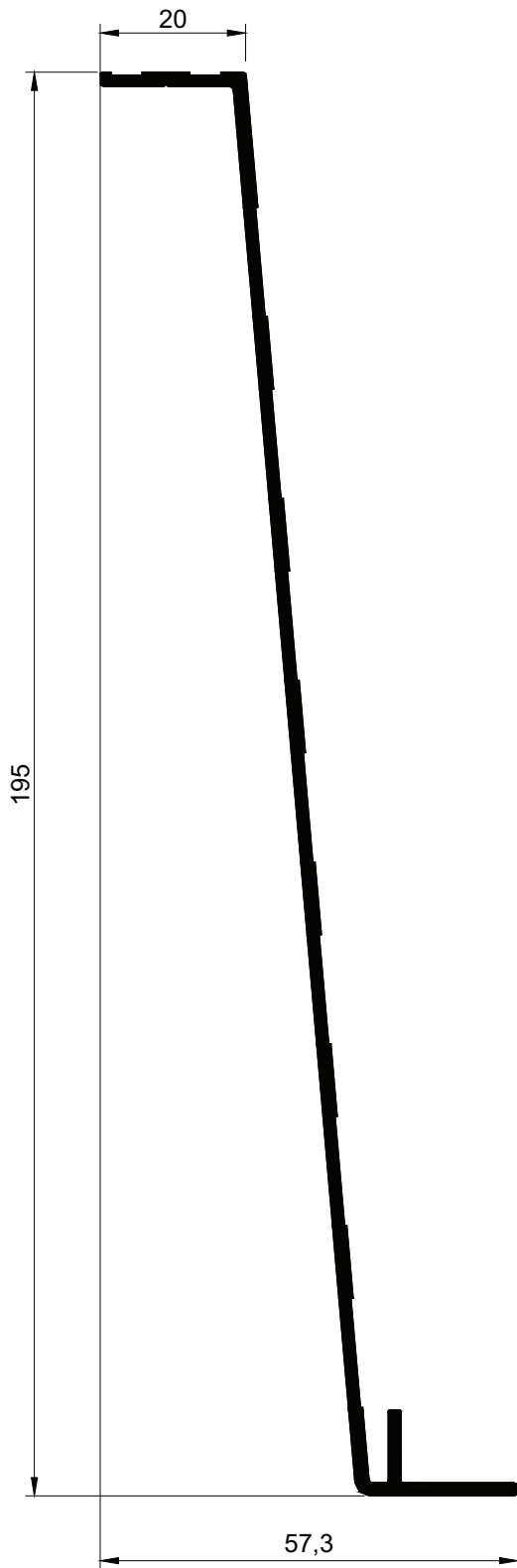

**3121**  $m = 1,206 \text{ kg/m}$

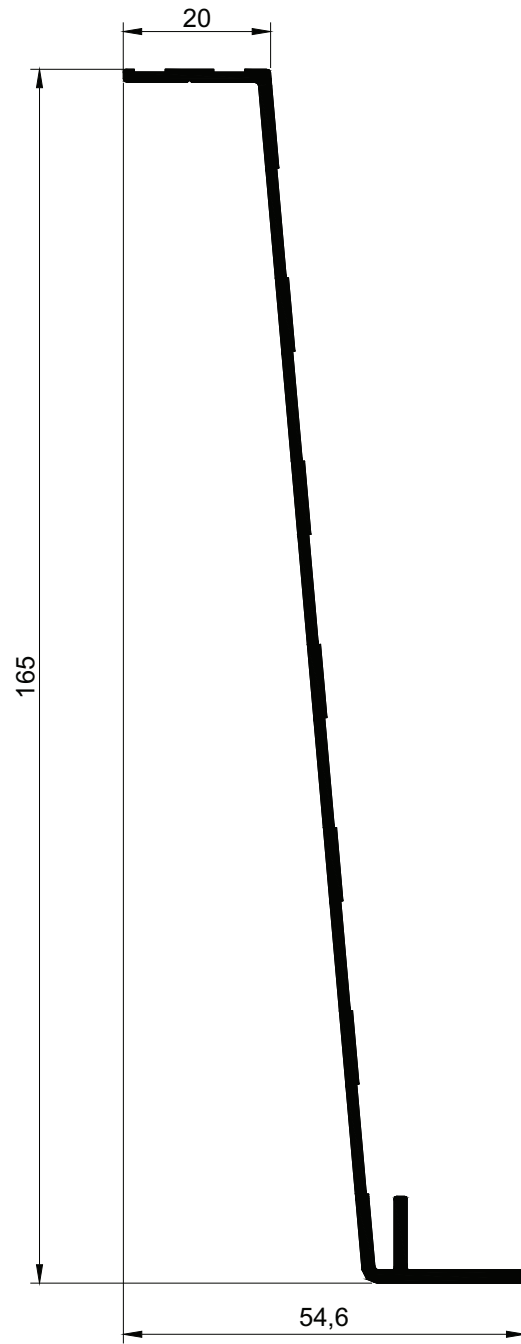

**3119**  $m = 0,957 \text{ kg/m}$

## Forme de profile

<b>Tevi rotunde</b>
<b>Tevi rectangulare</b>
<b>Tevi rectangulare racordate</b>
<b>Tevi patrute</b>
<b>Tevi patrute racordate</b>
<b>Profile cornier cu aripi egale</b>
<b>Profile cornier cu aripi inegale</b>
<b>Profile teu</b>
<b>Profile teu racordate</b>
<b>Profile U</b>
<b>Bare dreptunghiulare</b>
<b>Bare dreptunghiulare racordate</b>
<b>Bare hexagonale</b>
<b>Bare patrute</b>
<b>Bare rotunde</b>

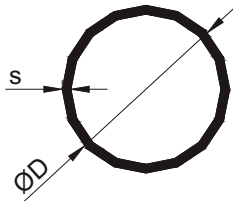

Cod	D mm	s mm	Masa kg/m
3301	50	1,7	0,697
3434	70	1,5	0,872
Alte dimensiuni la comanda speciala ØD max=100 mm ; s max=8 mm			

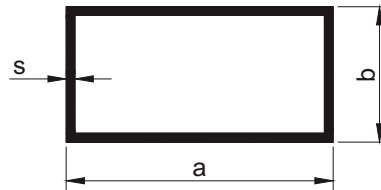

Cod	a mm	b mm	s mm	Masa kg/m
3017	40	20	1,2	0,374
3015	50	40	1,2	0,536
3014	67,5	27,5	1,2	0,608
Alte dimensiuni la comanda speciala a max=120 mm ; b max=80 mm ; s max=8 mm				

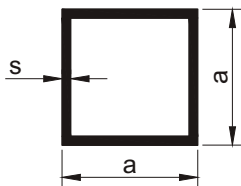

Cod	a mm	s mm	Masa kg/m
3019	40	1,2	0,503
Alte dimensiuni la comanda speciala a max=100 mm ; s max=8 mm			

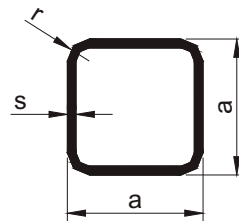

Cod	a mm	r mm	s mm	Masa kg/m
Dimensiuni la comanda speciala a max=100 mm ; s max=8 mm				

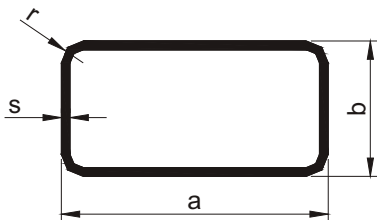

Cod	a mm	b mm	r mm	s mm	Masa kg/m
Dimensiuni la comanda speciala a max=120 mm ; b max=80 mm s max=8 mm					



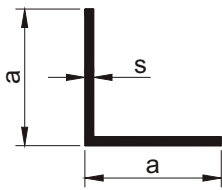

Cod	a mm	s mm	Masa kg/m
1206	15	1,2	0,094
1202	20	1,2	0,126
1207	25	1,2	0,158
1208	30	1,2	0,191
1211	40	1,2	0,255

Alte dimensiuni la comanda speciala  
 a max=100 mm ; s max=8 mm

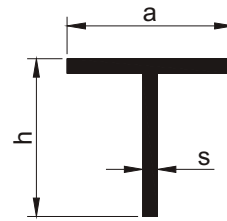

Cod	a mm	h mm	s mm	Masa kg/m
1300	15	15	1,2	0,094
1301	20	20	1,2	0,126
1302	25	25	1,2	0,158
1303	30	30	1,2	0,191

Alte dimensiuni la comanda speciala  
 a sau h max=100 mm ; s max=8 mm

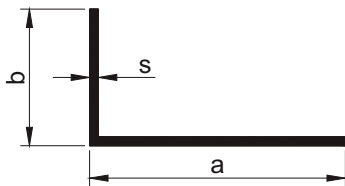

Cod	a mm	b mm	s mm	Masa kg/m
1209	40	20	1,2	0,191

Alte dimensiuni la comanda speciala  
 a max=120 mm ; b max=80 mm ; s max=8 mm

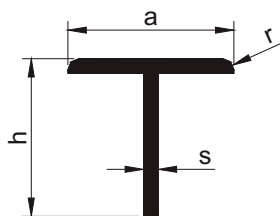

Cod	a mm	h mm	r mm	s mm	Masa kg/m
-----	------	------	------	------	-----------

Dimensiuni la comanda speciala  
 a sau h max=100 mm ; s max=8 mm

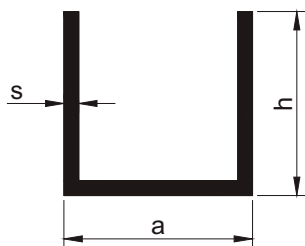

Cod	a mm	h mm	s mm	Masa kg/m
Dimensiuni la comanda speciala a sau h max=100 mm ; s max=8 mm				

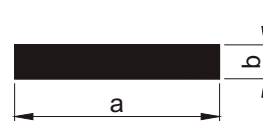

Cod	a mm	b mm	Masa kg/m
G-017	15	2,5	0,101
Alte dimensiuni la comanda speciala a max=150 mm ; b max=20 mm			

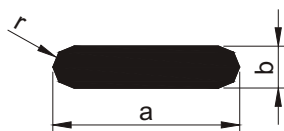

Cod	a mm	b mm	r mm	Masa kg/m
G-100	40	7	3,5	0,728
Alte dimensiuni la comanda speciala a max=150 mm ; b max=20 mm				



Cod	D mm	Masa kg/m
Dimensiuni la comanda speciala ØD max=100 mm		

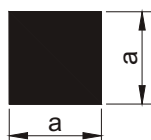

Cod	a mm	Masa kg/m
Dimensiuni la comanda speciala a max=70 mm		



Cod	a mm	Masa kg/m
Dimensiuni la comanda speciala a max=70 mm		



**BM MAGAZINS GRUP**

Depozit București  
Șoseaua Olteniței 204  
TEL: 021 492 08 52

**BM MAGAZINS GRUP**

Depozit Pitești  
Str. Depozitelor nr 6  
TEL: 0248 223 141

**BM MAGAZINS GRUP**

Depozit Bacău  
Str. Bârladului nr 23  
TEL: 0729 956 560

**DECOR AL  
BUCUREȘTI**

Str. Mihai Bravu 568 Sector 3  
Tel/Fax: 021 322 0317  
GSM: 0727 158 422  
0788 729 917

**SEBUMETAL BUCUREȘTI  
PANTELIMON**

B-DUL BIRUINȚEI NR 49  
COM. PANTELIMON  
TEL: 021 3500827

**MILITARI B-DUL IULIU  
MANIU 123-129**  
TEL: 021 3109106

**SUPER YILDIZ**

**SLATINA**  
STR. PITEȘTI F.N.  
TEL/FAX 0249 413.700

**SUPER YILDIZ**

**CRAIOVA**  
BLV. DECEBAL , NR 85  
TEL/FAX 0251.435.241

**SUPER YILDIZ**

**RÂMNICU VÂLCEA**  
LOCALITATEA BUJORENI  
C.F.R  
TEL/FAX 0250.717.215

**SUPER YILDIZ**

**DROBETA TURNU  
SEVERIN**  
STR. BANOVÎTEI NR. 3  
TEL/FAX: 0252.313.116

**SUPER YILDIZ**

**TARGU JIU**  
CALEA BUCUREȘTI  
NR. 250.B  
TEL/FAX: 0253.214.333

**SUPER YILDIZ**

**CONSTANȚA**  
STR. BABA NOVAC 169  
GSM: 0728 774 500  
TEL/FAX: 0241 878 628

**SC ODETTE SRL  
VASLUI**

Str. Călugăreni 105  
TEL : 0235 310 199  
GSM : 0744 768 488

**SC ODETTE SRL IAȘI**

Str. Calea Chișinăului 23  
TEL : 0232 22 00 76  
GSM : 0752 305 959

**SC ODETTE SRL  
FOCȘANI**

B-DUL BUCUREȘTI 12 A  
TEL : 0237 210 457  
GSM :0744 676 845

**SC ODETTE SRL  
TECUCI**

Str. Cuza Vodă nr. 68  
Tel: 0236 406 070  
Fax: 0236 817 972  
GSM: 0744 637 971

**SC DUCOMAR SRL  
TÂRGOVIȘTE**

Str. Aleea Sinaia nr. 7  
Tel/Fax: 0245 214 614  
GSM: 0722 620 643  
0788 676 343

**TERMOSERV MUREȘ S.A**

STR. ENERGETICII 1  
IERNUT , MUREȘ  
TEL: 0265 471 334  
FAX: 0256 471 288

**KRUSTA CONS SRL**

Str. Energiei 9  
ALBA IULIA  
0258 811 608  
GSM : 0744238752

**WINTECH DEVA**

TEL : 0254 232 282  
FAX : 0254 223 177  
GSM : 0729 967 254

**ALUMKRAFT GALAȚI**

STR. TECUCI NR 10  
(COLȚ CU MORILOR)  
TEL: 0236 460 308  
GSM: 0723 210 964

**ALUMKRAFT BRĂILA**

STR. ANCOREI NR 59-60  
TEL: 0239 612 467

**RGS PLOIEȘTI**

STR. POLIGONULUI NR. 1  
TEL/FAX: 0244 533 230  
GSM:0732 116 150

**EURO BUSINESS**

**PLOIEȘTI**  
Str. Poligonului nr. 1  
(Incinta Aquila)  
Tel/Fax: 0244 599 519  
GSM: 0726 206 900

**PANFORT S.N.C RM SĂRAT**

PIAȚA HALELOR  
TEL/FAX: 0238 566 299  
GSM: 0723 276 465